



HAWAIIAN HOME LANDS TRUST

- a me -

KAMEHAMEHA SCHOOLS



KA PUA INITIATIVE AT MĀ‘ILĪ

Nā Ali‘i



Princess
Bernice Pauahi Bishop



Prince
Jonah Kūhiō Kalanianaʻole

Pūpūkahi I Holomua

- ◎ The legacies of our Ali‘i moving forward
 - Our commonalities — Native Hawaiian beneficiaries, future of ka po‘e Hawai‘i, large land-holdings
 - How we can help each other: Joint development; collocation (people near resources), lease rent.
 - In working together, we strengthen both trusts and better serve a wider range of needs for our Hawaiian communities.



HAWAIIAN HOME LANDS TRUST

- A ME -

KAMEHAMEHA SCHOOLS



BACKGROUND

Voice of America Site



Voice of America Site

- ◉ Alternate site after Mākaha
- ◉ 89 acres at Mā‘ili
- ◉ Old Voice of America antenna site
- ◉ Came into the Hawaiian Home Lands trust via federal surplus lands program
- ◉ Centrally-located along the Leeward Coast
- ◉ Relatively flat, easily accessible and close to infrastructure.
- ◉ Infrastructure development cost likely less than in Mākaha

Status

- Hawaiian Home Lands and Kamehameha Schools remain committed to developing a world class learning center surrounded by a community of Native Hawaiians along the Leeward Coast.
- The Hawaiian Homes Commission and Kamehameha Schools Trustees have entered into a Memorandum of Understanding related to developing the Voice of America Site for this purpose.
- Enter into a formal lease agreement.



KAMEHAMEHA SCHOOLS

KA PUA INITIATIVE



Growing Our Keiki and Community Together

● KS' Ka Pua Initiative is a long term commitment to:

- Excellent education
- Strong community
- Committed presence on the Wai'anāe Coast

● Vision: To support a healthy, vibrant Native Hawaiian community whose youth and families:

- Lead for the future
- Are firmly grounded in knowing who they are and where they come from



Ka Pua



KAMEHAMEHA SCHOOLS®

INITIATIVE

Ka Pua Initiative



Currently Ka Pua focuses on three strategic priorities, that build toward increased community engagement and capacity building.

- ◉ All children succeeding
- ◉ All children supported
- ◉ Quality infrastructure & pride in place

Ka Pua



KAMEHAMEHA SCHOOLS®

INITIATIVE

Ka Pua Initiative

Three Strategic priorities:

- **All Children Succeed**

The College Success Council (CSC) continues work to support every student on the Wai‘anae Coast to have the choice, vision and support to achieve post-secondary success.

- College Knowledge, Way Finding, Key Content and Cognitive Strategies
- College Campus Exposure
- Mock Interviews
- Career Professional Network
- ‘Ohana ‘Ike Program



Ka Pua



INITIATIVE

Ka Pua Initiative

Three Strategic priorities:

- **All Children Supported**

The Hawai‘i State DOE Race to the Top Wraparound Services effort centers on a goal of getting kids to school, keeping kids in school and engaging them in learning. Our role serves as a bridge and brings a diverse set of community resources that the DOE doesn’t normally access.

- After School Programs
- Sports
- Academic Enrichment
- Social and Health Services



Ka Pua



KAMEHAMEHA SCHOOLS®

INITIATIVE

Ka Pua Initiative

Three Strategic priorities:

- **Quality Infrastructure and Pride in Place**
- **Community collaborator sites and programs**

Kamehameha Community Learning Center (KCLC) will be new learning facilities that supplement existing community efforts.



Ka Pua



KAMEHAMEHA SCHOOLS®

INITIATIVE



KAMEHAMEHA SCHOOLS

Learning Center at Māʻili



Ka Pua



KAMEHAMEHA SCHOOLS®

INITIATIVE

Ka Pua



KAMEHAMEHA SCHOOLS®

INITIATIVE



Ka Pua Initiative

- KS and HHL have entered into a Memorandum of Understanding to explore a lease opportunity of approximately 40 acres to develop a Learning Center. HHL is exploring ideas to develop housing surrounding the learning center to create a one-of-a-kind learning community
- Location:
 - Access from St. John's Road or Kaukama Rd.
 - Former Voice of America Site
- Status: Pending final Trustee approval
 - Ceremonial lease signing ceremony at the site – June 19
 - Projected lease execution – June 29

Ka Pua



KAMEHAMEHA SCHOOLS®

INITIATIVE



HAWAIIAN HOME LANDS TRUST

HAWAIIAN HOME LANDS

Hawaiian Home Lands Role

- HHL wants to facilitate KS's development of educational facilities along the coast.
- HHL provides the site.
- HHC is able to extend its land use authorities.
- Facilitate infrastructure development partnership to cut costs.
- Work with KS to include homesteaders in community outreach.
- Facilitate beneficiary consultation.
- New strategic plan calls for developing multi-family housing initiatives and Ka Pua at Mā'ili is one of the sites.

DHHL Multi-Family Housing Ideas

- Low density townhouses or walk-ups.
- Transitional housing, i.e., rent-to-own, housing for single couples, etc.
- Cultural village concept – cluster homes with open space for families to congregate.
- Kūpuna housing.
- Housing for native practitioners who want to teach and pass on native Hawaiian intelligence or cultural knowledge.
- Community facilities, parks, commercial kitchens and other community spaces.
- Dormitories for students and/or teachers linked to KS Ka Pua programs.

Joint Planning Process

- Past six months DHHL and KS Staff involved in the charrette planning process.
- Detailed, intensive planning process that develops the spatial relationships on the site.
- Looked at programmatic elements to guide land use design.
- Tonight we are sharing some of the conceptual relationships we developed in the process.
- Tonight's discussion we would like to hear your mana'o on these concepts.

FUNCTIONAL RELATIONSHIPS



FUNCTIONAL RELATIONSHIPS

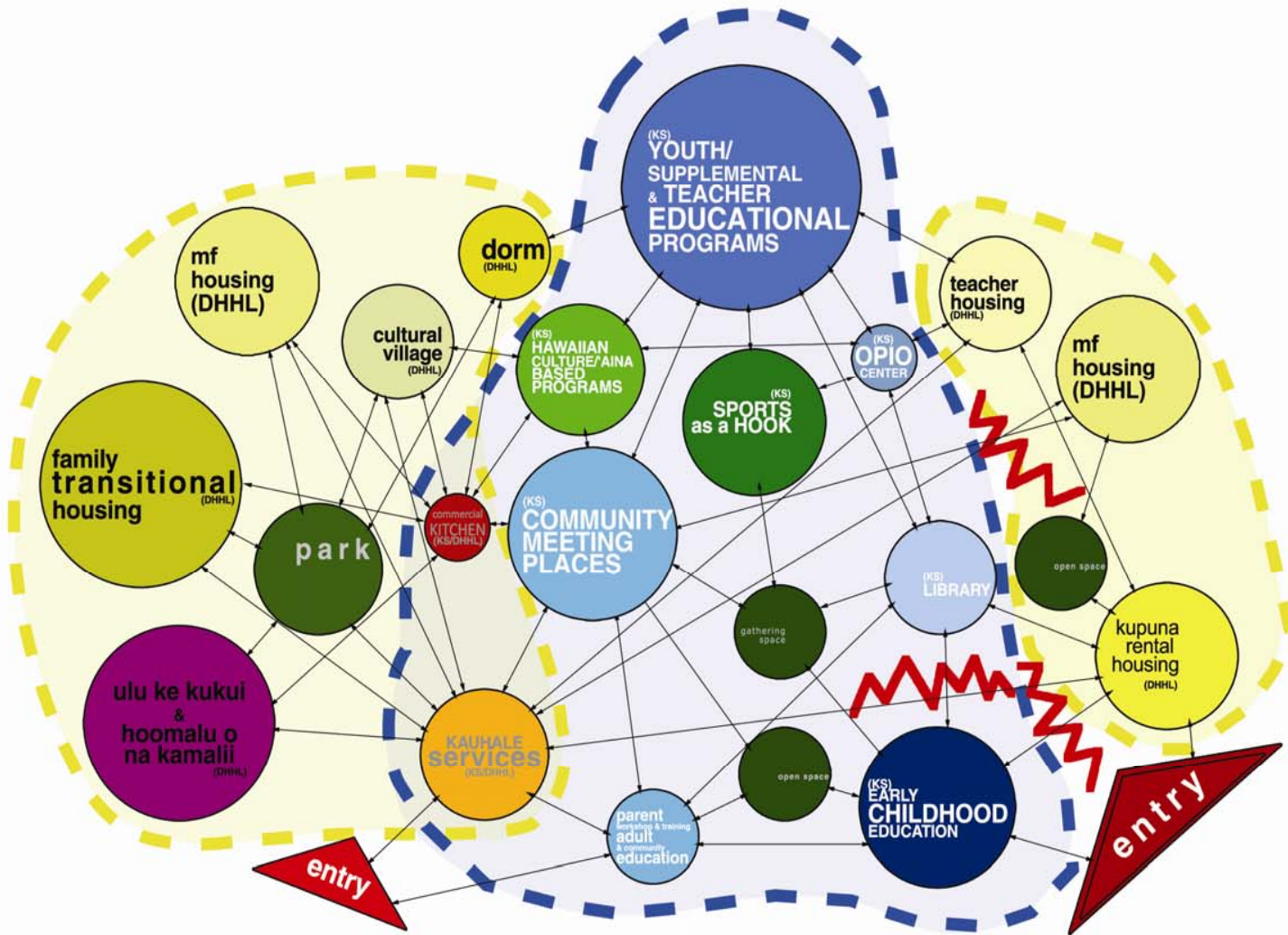

Functional Relationship Diagram

CONCEPTUAL LAND USE DESIGNS

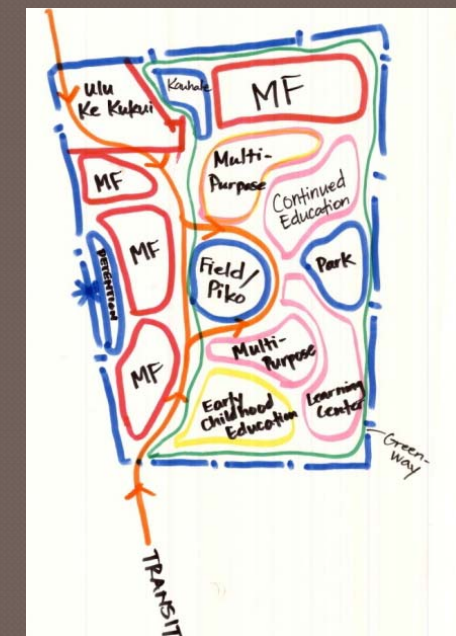
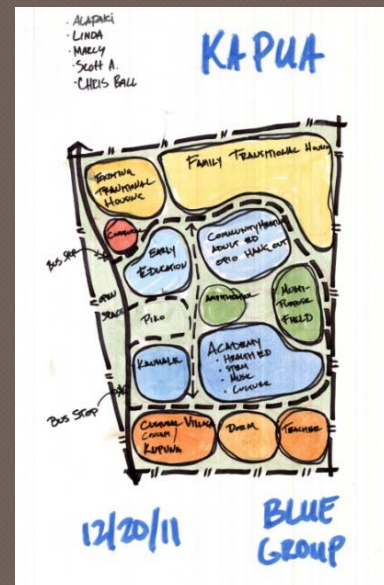
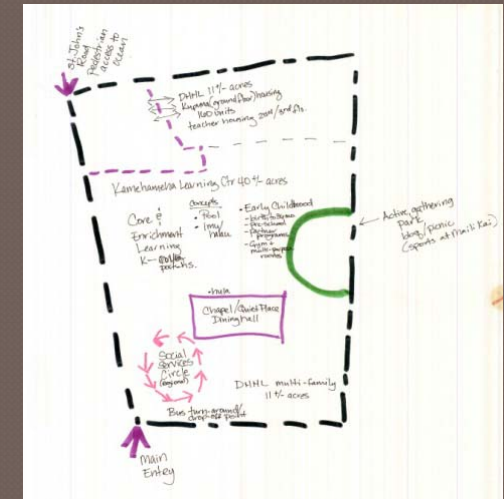
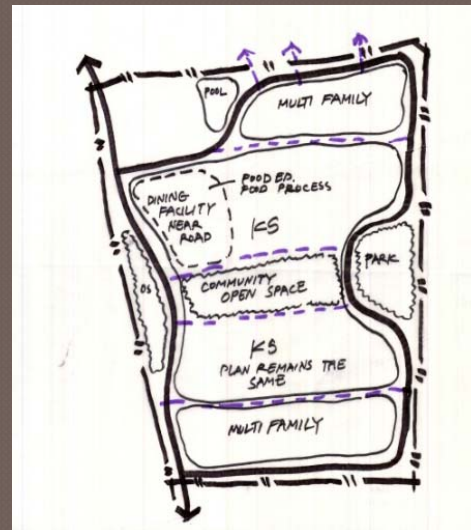

INTEGRATED LAND USE DESIGNS

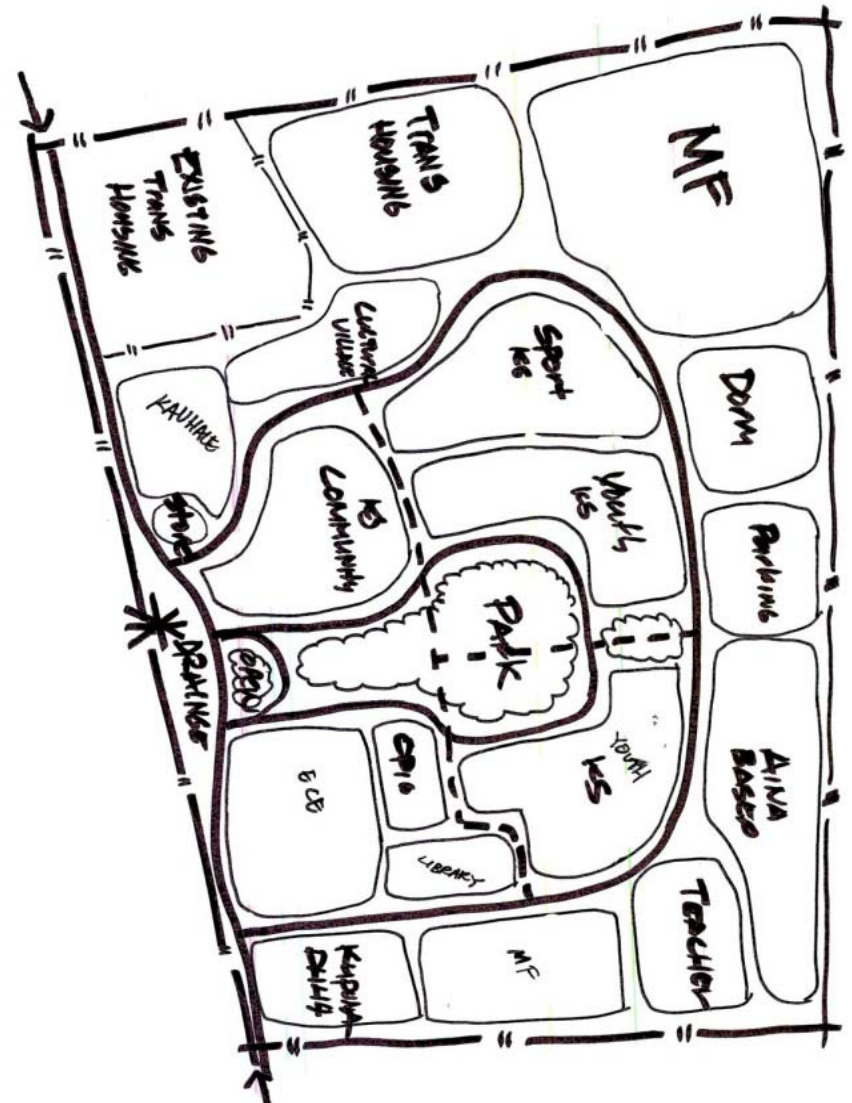

Next Steps

- ◉ Step 1: Decide on a final conceptual land use plan.
- ◉ Step 2: Enter into a ground lease agreement.
- ◉ Step 3: Due diligence work including environmental assessments which will have separate opportunities for public input.
- ◉ Step 4: Enter into a development agreement.
- ◉ Step 5: Design, site prep and construction.
- ◉ Step 6: Eventually work toward land exchange.

Summary

- ◎ The Leeward Coast would be home to a world-class educational learning center.
- ◎ Our Hawaiian children for generations to come will benefit from a confluence of educational initiatives in this region.
- ◎ DHHL would be able to develop infrastructure at a reduced, shared cost.
- ◎ DHHL and applicants will pioneer new ground relating to multi-family housing as a homestead alternative.
- ◎ Two Ali 'i trusts to leverage their respective resources in order to reduce cost, save time and meet needs – Hawaiians helping Hawaiians.

Mahalo!



HAWAIIAN HOME LANDS TRUST

www.hawaiianhomelands.org

twitter.com/dhhl

facebook.com/hawaiianhomelands

youtube.com/thedhhl

flickr.com/dhhl



KAMEHAMEHA SCHOOLS

Visit us: www.ksbe.edu

Follow us:  [/ksnews](https://twitter.com/ksnews)

Like us:  [/kamehamehaschools](https://facebook.com/kamehamehaschools)

Watch us:  [/kamehamehaschools](https://youtube.com/kamehamehaschools)