



Department of Hawaiian Home Lands

Kānehiki

Orientation Meeting

**Kapolei High School Cafeteria
July 20, 2019**

Announcements

- **Restrooms**
- **No smoking**
- **Please keep your area clean**
- **Avoid distractions**
- **Support Desk available**

Agenda

- **Introduction** (Paula)
- **Kanehili** (Darrell)
- **Turnkey Program** (Gentry)
- **Financing** (Engel & Volkers)
- **Lot Selection Ground Rules** (Paula)
- **Awards Process** (Paula)
- **Important Dates** (Paula)



Department of Hawaiian Home Lands



Prince Jonah Kuhio Kalaniana'ole



Department of Hawaiian Home Lands

DHHL Kanehili Project Team

Darrell Ing

Michelle Hitzeman

Kaila Bolton

Paula Aila



Department of Hawaiian Home Lands

DHHL Partners



GENTRY



VA



U.S. Department
of Veterans Affairs



ENGEL & VÖLKERS
Honolulu





Department of Hawaiian Home Lands

Land Development Division

University of Hawaii
West Oahu

Kualaka'i Parkway



Incr II-C **Ka'uluokaha'i**

Incr II-B

Incr II-A

Kānehili

Hale
Kalaniana'ōle

Kapolei Parkway



**Ka Makana
Ahi**



Ka Makāna Ali'i



Ka'uluokaha'i

Kānehili



Available Turnkey Lots

- **37 lots remaining in subdivision**
- **The same Lot Selection Ground Rules will be followed until all 37 lots have been offered and selected**

Available Lots

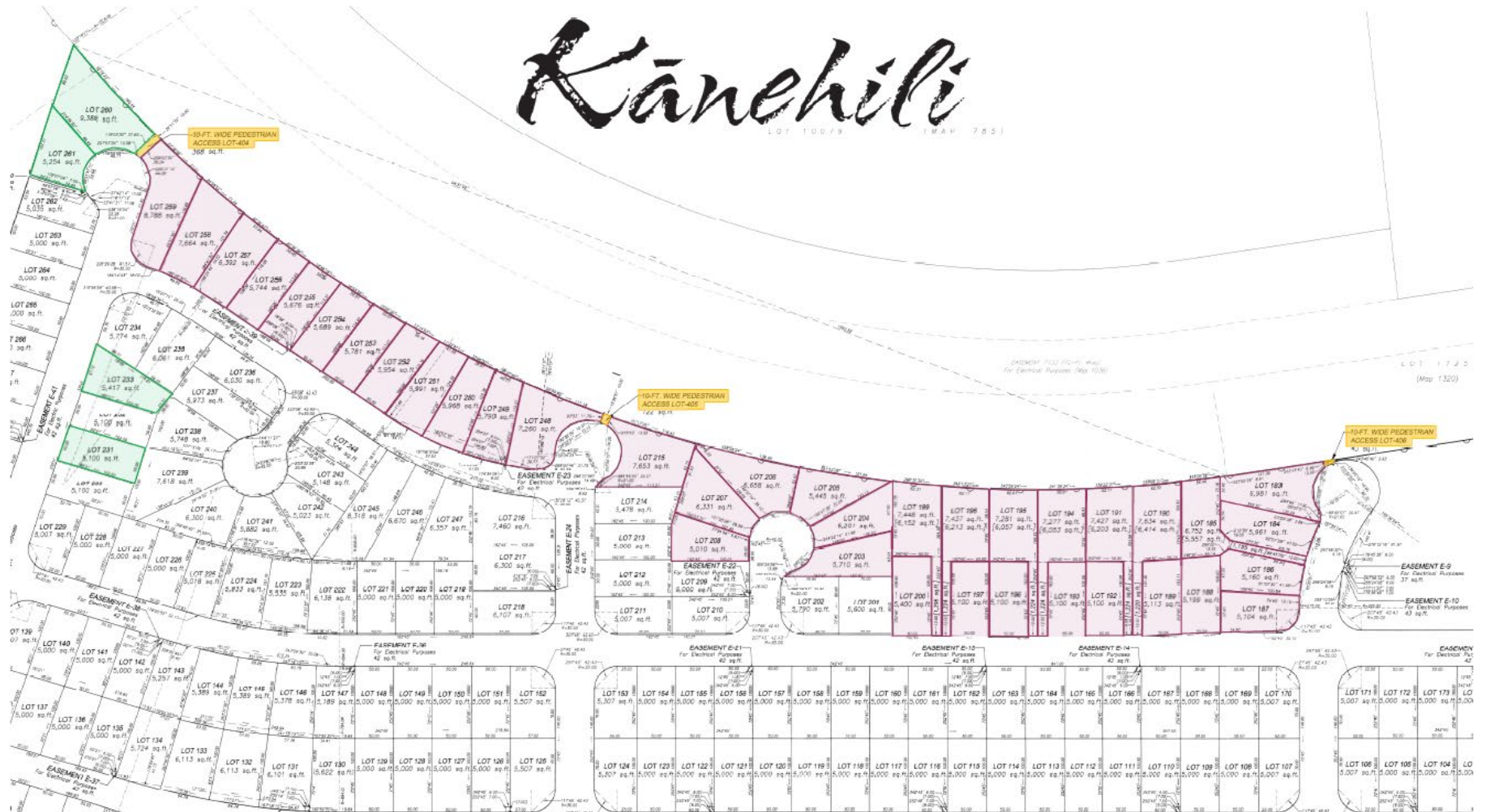

FINAL OFFERING - 37 LOTS

COMMITTED FOR HABITAT SELF-HELP

Lot Matrix

Lot No.	LC Lot No.	TMK	Address	Lot Size (sq.ft.)	Subdiv Map Easement	LC Easement	Easement Area	Easement Purpose	Remarks
183	18473	9-1-152: 127	91-1076 Kamakahahei Street	6,981					Cul-de-sac; next to pedestrian Walkway
184	18474	9-1-152: 128	91-1070 Kamakahahei Street	5,961					
185	18475	9-1-152: 129	91-1068 Kamakahahei Street	6,752					Flag lot
186	18476	9-1-152: 130	91-1066 Kamakahahei Street	5,160					
187	18477	9-1-152: 131	91-1062 Kamakahahei Street	5,104					
188	18478	9-1-152: 132	91-1291 Kekahili Street	5,199					
189	18479	9-1-152: 133	91-1293 Kekahili Street	5,113					
190	18480	9-1-152: 134	91-1295 Kekahili Street	7,634					Flag lot
191	18481	9-1-152: 135	91-1297 Kekahili Street	7,427					Flag lot
192	18482	9-1-152: 136	91-1299 Kekahili Street	5,100					
193	18483	9-1-152: 137	91-1301 Kekahili Street	5,100					
194	18484	9-1-152: 138	91-1303 Kekahili Street	7,277					Flag lot
195	18485	9-1-152: 139	91-1305 Kekahili Street	7,281					Flag lot
196	18486	9-1-152: 140	91-1307 Kekahili Street	5,100					
197	18487	9-1-152: 141	91-1311 Kekahili Street	5,100					
198	18488	9-1-152: 142	91-1313 Kekahili Street	7,437					Flag lot
199	18489	9-1-152: 143	91-1315 Kekahili Street	7,448					Flag lot
200	18490	9-1-152: 144	91-1317 Kekahili Street	5,400					
203	18493	9-1-152: 147	91-505 Kekahili Place	5,710					Cul-de-sac
204	18494	9-1-152: 148	91-509 Kekahili Place	5,201					Cul-de-sac
205	18495	9-1-152: 149	91-513 Kekahili Place	5,445					Cul-de-sac
206	18496	9-1-152: 150	91-518 Kekahili Place	6,658					Cul-de-sac
207	18497	9-1-152: 151	91-514 Kekahili Place	6,331					Cul-de-sac
208	18498	9-1-152: 152	91-510 Kekahili Place	5,010					Cul-de-sac
215	18505	9-1-152: 159	91-1277 Kuma'aiku Street	7,653					Cul-de-sac; next to pedestrian Walkway
248	18538	9-1-153: 001	91-1001 Ka'apuwai Street	7,261					Cul-de-sac; next to pedestrian Walkway
249	18539	9-1-153: 002	91-1005 Ka'apuwai Street	5,790	E-23	10116	42 sq. ft.	electrical	
250	18540	9-1-153: 003	91-1009 Ka'apuwai Street	5,969					
251	18541	9-1-153: 004	91-1013 Ka'apuwai Street	5,992					
252	18542	9-1-153: 005	91-1017 Ka'apuwai Street	5,954					
253	18543	9-1-153: 006	91-1021 Ka'apuwai Street	5,781					
254	18544	9-1-153: 007	91-1023 Ka'apuwai Street	5,688					
255	18545	9-1-153: 008	91-1027 Ka'apuwai Street	5,676	E-39	10132	42 sq. ft.	electrical	
256	18546	9-1-153: 009	91-1031 Ka'apuwai Street	5,774					
257	18547	9-1-153: 010	91-1033 Ka'apuwai Street	6,392					
258	18548	9-1-153: 011	91-1037 Ka'apuwai Street	7,665					
259	18549	9-1-153: 012	91-1041 Ka'apuwai Street	8,790					Cul-de-sac; next to pedestrian Walkway
			Average	6,198					

Proposed Construction Schedule

- **House construction start**
 - **December 2019**
- **First house complete**
 - **April 2020**

Kānehiki



GENTRY

Tom Gentry

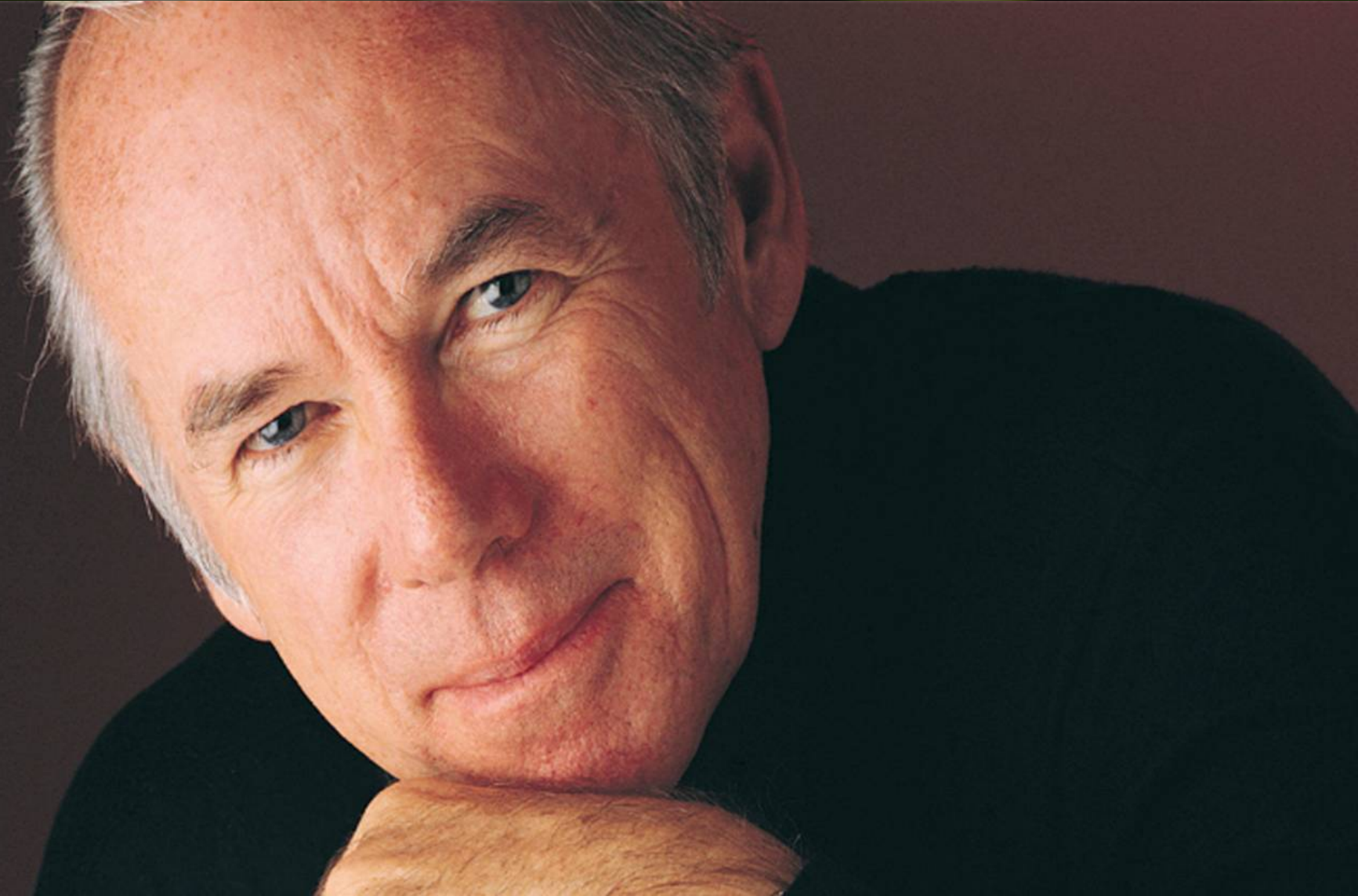

Quality Construction



Superior Customer Care



Energy Saving Features

- **Low E Dual paned vinyl windows**
- **20-SEER central air conditioning**
- **Solar hot water heating system**
- **Spray foam insulation**
- **LED light package**
- **Insulated roll up garage door with remotes**



Kitchen Appointments

- **GE ceramic top electric range with self-cleaning oven**
- **Ge Microwave/hood**
- **GE dishwasher**
- **Designer laminate kitchen cabinets**
- **Stainless steel kitchen sink**
- **Kohler plumbing fixtures**

Comfort Features

- **Wall to wall carpet**
- **No wax resilient vinyl flooring at entry, kitchen, bathrooms**
- **Spacious walk-in closet in master bedrooms**
- **Dual wash basins in master bathrooms (except Plan A & B)**
- **Mirrored sliding closet doors (in select rooms)**
- **Corian bathroom vanity tops**

Warranty = Quality

- **30 year warranty on Borate treated lumber**
- **Limited lifetime warranty on composite roof**
- **30 year warranty on Hardi siding**
- **Limited lifetime warranty on vinyl fencing with gate**



Value-Added Features

- **Front yard landscaping**
- **Gravel edging**
- **Vinyl privacy fence and gate**
- **Seller incentive to use approved lender**

Optional Upgrades

- **Covered lanais**
- **Stainless steel appliances**
- **Washer/dryer**
- **Ceiling fans**
- **Wireless security system**
- **Flooring upgrade package**



ENGEL & VÖLKERS[®]

Honolulu



Joyce Tsubota
Project Manager
(808) 358-8821

Joyce.Tsubota@evusa.com



ENGEL & VÖLKERS®

Honolulu



Kelly Hiraki
Project Asst.
(808) 499-7409

Kelly.Hiraki@evusa.com



Ernest Yagi
Sales Advisor
(808) 479-9343

Ernest.Yagi@evusa.com



Maila Gibson-Bandmann
Sales Advisor
(808) 295-4494

Maila.GibsonBandmann@evusa.com



Kaniela Kimura
Sales Advisor
(808) 286-5939

Kaniela.Kimura@evusa.com



Topa Financial Center
745 Fort Street Mall, Suite 608
Honolulu, Hawaii 96813
Office: (808) 550-0818
Fax: (808) 550-0819
www.honolulu.evusa.com

Stadium Mall
4510 Salt Lake Boulevard., #B-4
Honolulu, Hawaii 96818
Office: (808) 487-3855
Fax: (808) 369-8898
www.honolulu.evusa.com



Financing



Loan Programs and Lenders

- **FHA 247 & 184A and USDA-Guaranteed**
 - Bank of Hawaii
 - Guild Mortgage
 - Homebridge Financial Services
 - Homestreet Bank
 - Freedom Mortgage
- **VA**

Turn-key Lot Selection Ground Rules

Kānehiki

Turn-key Lot Selection Ground Rules

- You must be present or have a notarized authorized proxy present to select a lot for you
- Bring a current picture ID (state ID, military ID or driver's license) in order to select
- Bring a copy of your pre-qualification letter
- If you come in after your name is called, you may select, if lots are still available

Turn-key Lot Selection Ground Rules

- An earnest money deposit of \$1,000 made payable to Title Guaranty Escrow Services, Inc. due at contract signing
- An additional deposit equal to 50% of the total option amount, made payable to Title Guaranty Escrow Services, Inc. due at contract signing
- Cashier's checks or money orders only – cash will not be accepted

Back Up List

- If all lots have been selected before your name is called, you will be placed on a back up list based on your original date of application.
- Back up list will expire once all thirty-seven (37) lots have been awarded.

Deferrals

- **If you are no longer interested:**
 - **Complete the Response Form (at Support Desk)**
 - **You will remain on the Oahu Islandwide Residential Wait list**

Award Process Turnkey Homes

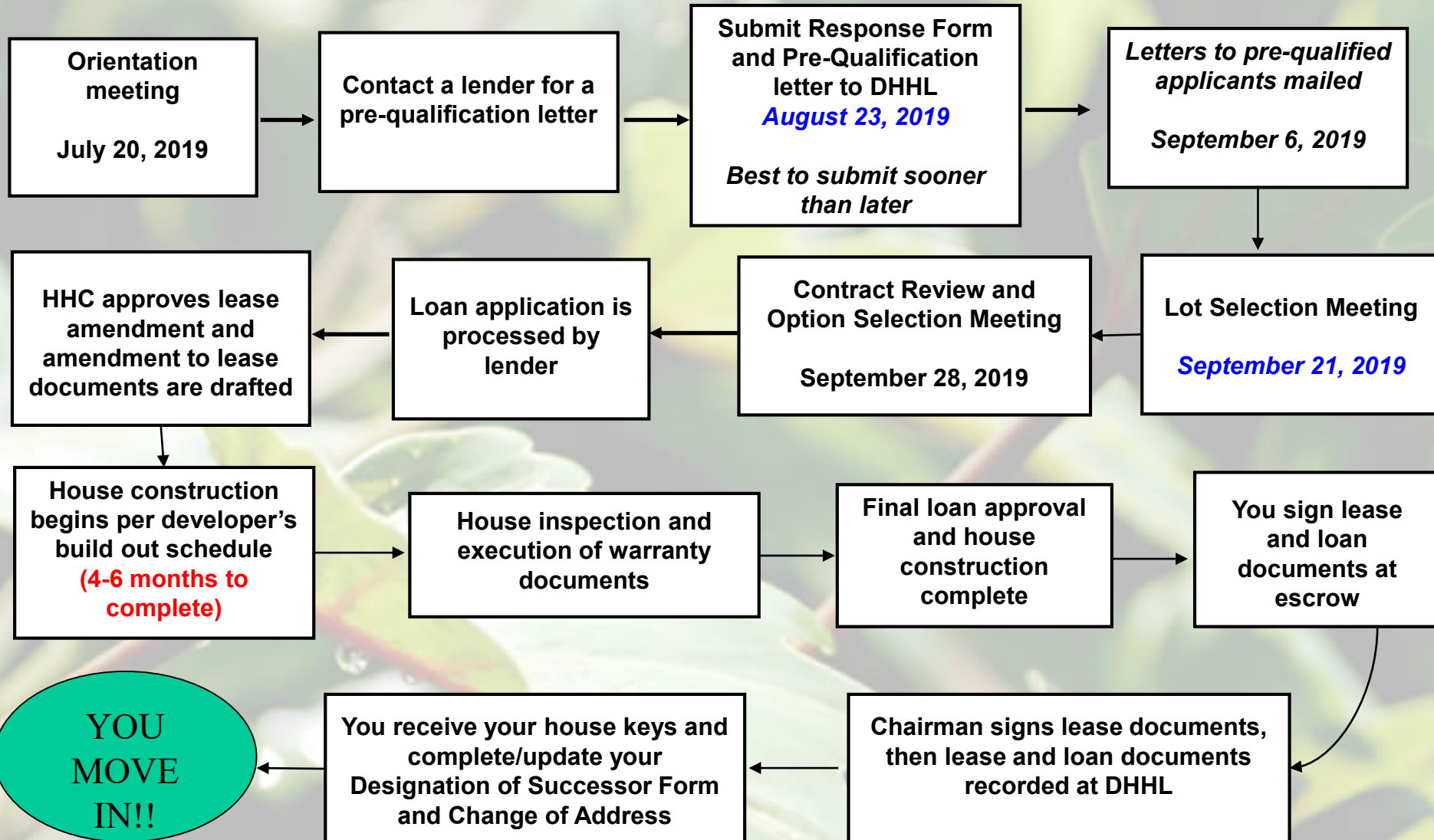

Important Dates

Model Home Preference Response Form Due

– August 23, 2019

Pre-Qualification Letter Due

– August 23, 2019, but sooner is best

Lot Selection Meeting

– September 21, 2019

Contract Review and Option Selection Meeting

– September 28, 2019

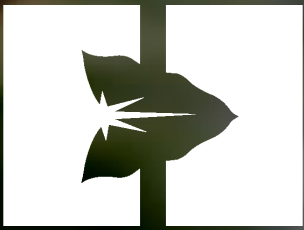

Questions?