

CONSTRUCTION PLANS
FOR
KANEHILI PEDESTRIAN ACCESS
HONOULIULI, EWA, OAHU, HAWAII

OWNER AND DEVELOPER: DEPARTMENT OF TRANSPORTATION
DEPARTMENT OF HAWAIIAN HOME LANDS

TAX MAP KEY: 9-1-153:194
TAX MAP KEY: 9-1-152:160
TAX MAP KEY: 9-1-151:001
TAX MAP KEY: 9-1-017:096



Community Planning and Engineering, Inc.
Engineering Design | Construction Management | Infrastructure Planning
1286 Queen Emma Street Honolulu, Hawaii

INDEX TO DRAWINGS

<u>SHT. NO.</u>	<u>DWG. NO.</u>	<u>DESCRIPTION</u>
1	T-1	TITLE SHEET
2	C-1	CONSTRUCTION NOTES
3	C-2	PLAN - 1
4	C-3	PLAN - 2
5	C-4	PLAN - 3
6	C-5	DETAILS
7	C-6	TRAFFIC CONTROL PLAN

A P P R O V E D



CHAIRMAN, HAWAIIAN HOMES COMMISSION
DEPARTMENT OF HAWAIIAN HOME LANDS
STATE OF HAWAII

6/13/19
DATE

ADMINISTRATOR, HIGHWAYS DIVISION
STATE DEPARTMENT OF TRANSPORTATION (APPROVAL GRANTED FOR
WORK WITHIN STATE RIGHT-OF-WAY ONLY. I.D. NO. 0-18-05
LETTER OF APPROVAL NO. HWY-CM 2.0341
DATED 6/26/19)

6/26/19
DATE

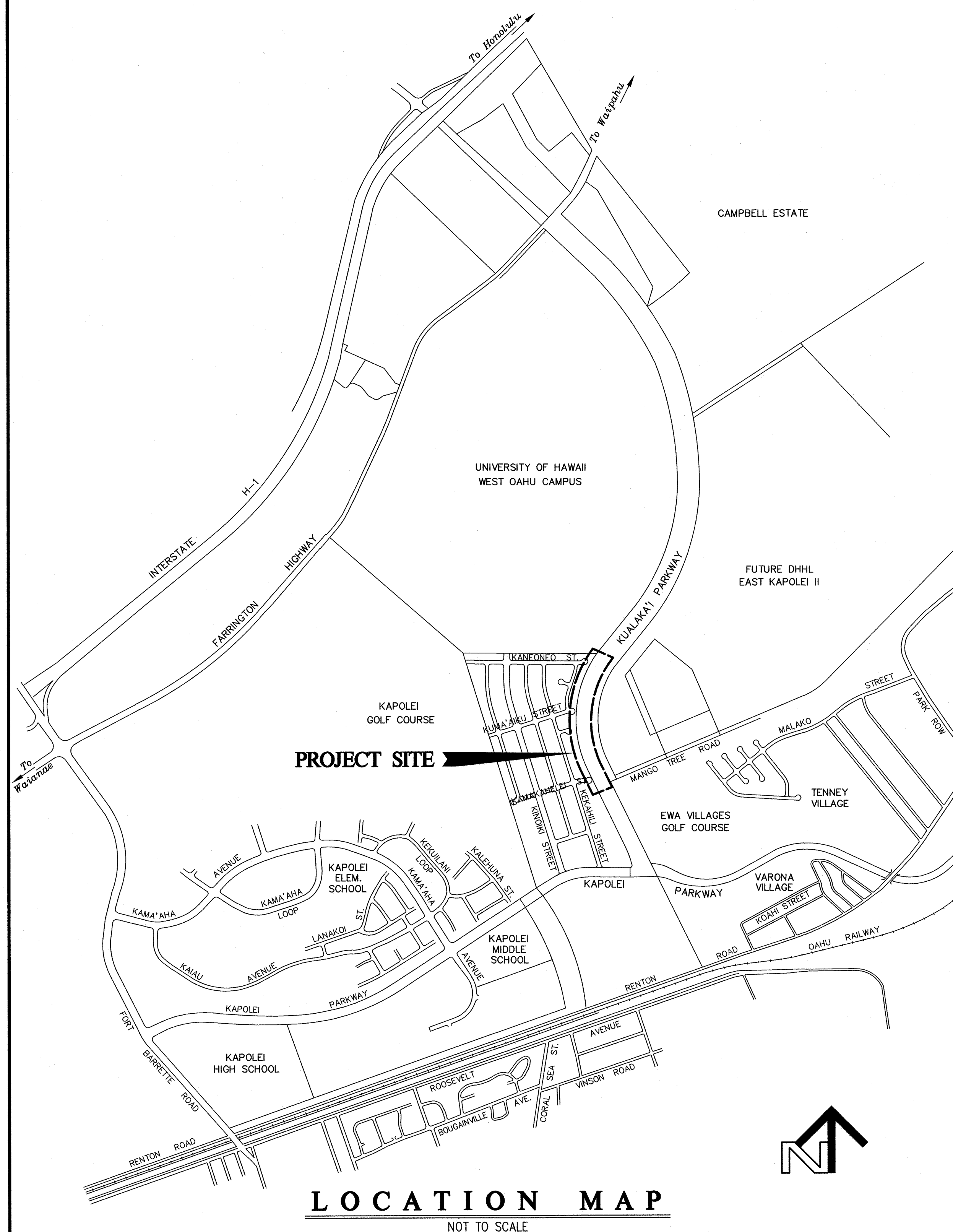
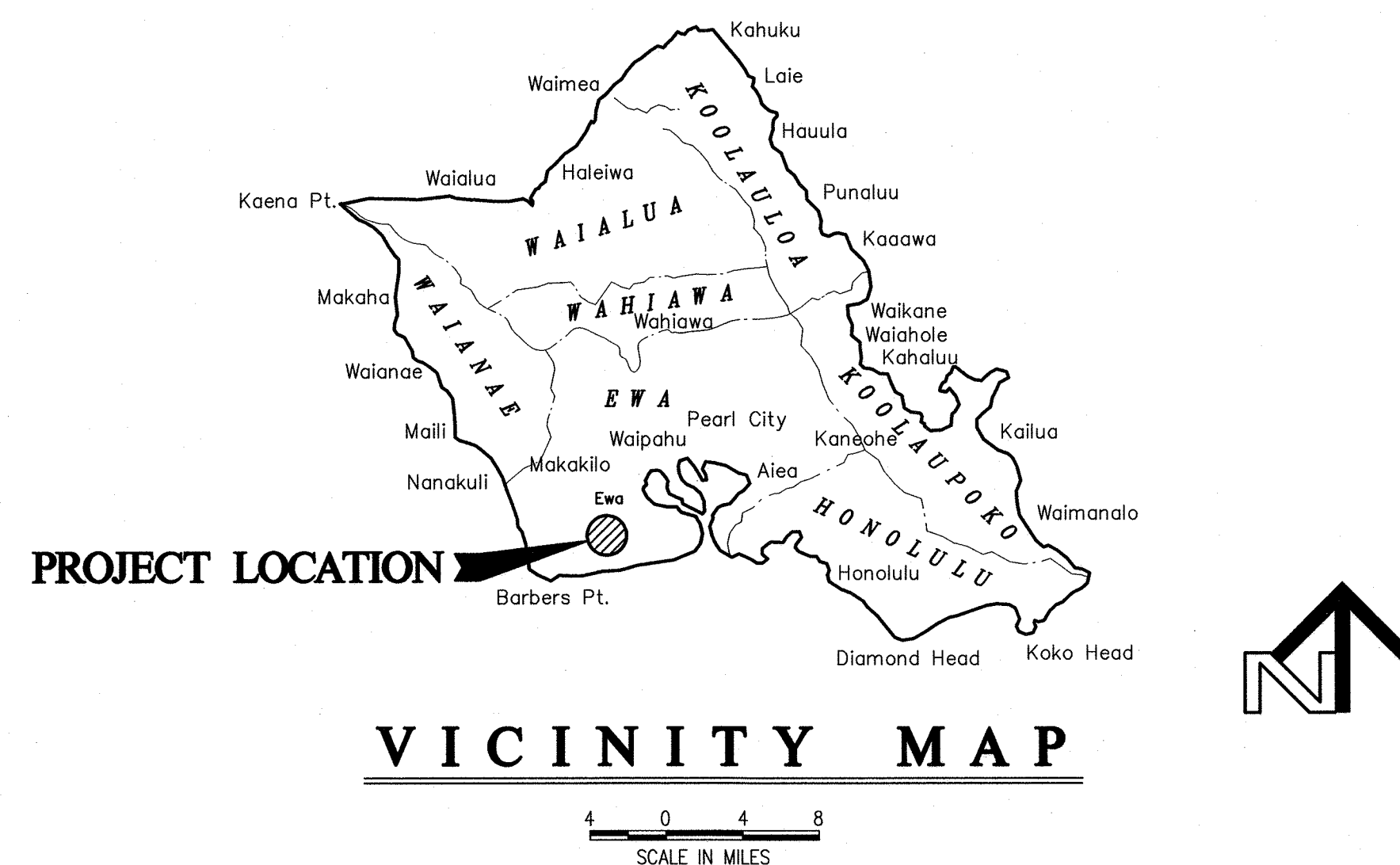

GENERAL NOTES

- THE CONTRACTOR SHALL OBSERVE AND COMPLY WITH ALL FEDERAL, STATE AND LOCAL LAWS REQUIRED FOR THE PROTECTION OF PUBLIC HEALTH, SAFETY AND ENVIRONMENTAL QUALITY.
- UTILITIES SHALL BE INSTALLED IN ACCORDANCE WITH ORDINANCE NOS. 2875 AND 3375 (UNDERGROUND UTILITIES).
- NO CONTRACTOR SHALL PERFORM ANY CONSTRUCTION OPERATION SO AS TO CAUSE FALLING ROCKS, SOIL OR DEBRIS IN ANY FORM TO FALL, SLIDE OR FLOW INTO EXISTING CITY DRAINAGE SYSTEMS, OR ADJOINING PROPERTIES, STREETS OR NATURAL WATERCOURSES. SHOULD SUCH VIOLATIONS OCCUR, THE CONTRACTOR MAY BE CITED AND THE CONTRACTOR SHALL IMMEDIATELY MAKE ANY REMEDIAL ACTIONS NECESSARY.
- THE CONTRACTOR, AT HIS OWN EXPENSE, SHALL KEEP THE PROJECT AND SURROUNDING AREA FREE FROM DUST NUISANCE. THE WORK SHALL BE IN CONFORMANCE WITH THE AIR POLLUTION CONTROL STANDARDS AND REGULATIONS OF THE STATE DEPARTMENT OF HEALTH.
- THE UNDERGROUND PIPES, CABLES OR DUCTLINES KNOWN TO EXIST BY THE ENGINEER FROM HIS SEARCH OF RECORDS ARE INDICATED ON THE PLANS. THE CONTRACTOR SHALL VERIFY THE LOCATIONS AND DEPTHS OF THE FACILITIES AND EXERCISE PROPER CARE IN EXCAVATING IN THE AREA WHEREVER CONNECTIONS OF NEW UTILITIES TO EXISTING UTILITIES ARE SHOWN ON THE PLANS, THE CONTRACTOR SHALL EXPOSE THE EXISTING LINES AT THE PROPOSED CONNECTIONS TO VERIFY THEIR LOCATIONS AND DEPTHS PRIOR TO EXCAVATION FOR THE NEW LINES.
- THE CONTRACTOR SHALL BE RESPONSIBLE FOR CONFORMANCE WITH THE APPLICABLE PROVISIONS OF THE WATER QUALITY AND WATER POLLUTION CONTROL STANDARDS CONTAINED IN HAWAII ADMINISTRATIVE RULES, TITLE 11, CHAPTER 54, "WATER QUALITY STANDARDS", AND TITLE 11, CHAPTER 55, "WATER POLLUTION CONTROL", AS WELL AS CHAPTER 14 OF THE REVISED ORDINANCES OF HONOLULU, AS AMENDED. BEST MANAGEMENT PRACTICES SHALL BE EMPLOYED AT ALL TIMES DURING CONSTRUCTION.
- ALL EXISTING UTILITIES, WHETHER OR NOT SHOWN ON THE PLANS, SHALL BE PROTECTED AT ALL TIMES UNLESS OTHERWISE NOTED.
- THE CONTRACTOR SHALL PROVIDE, INSTALL AND MAINTAIN ALL NECESSARY SIGNS, LIGHTS, FLARES, BARRICADES, MARKERS, CONES, AND OTHER PROTECTIVE FACILITIES, AND SHALL TAKE ALL NECESSARY PRECAUTIONS FOR THE PROTECTION, CONVENIENCE AND SAFETY OF THE PUBLIC.
- PURSUANT TO CHAPTER 6E, HRS, IN THE EVENT ANY ARTIFACTS OR HUMAN REMAINS ARE UNCOVERED DURING CONSTRUCTION OPERATIONS, THE CONTRACTOR SHALL IMMEDIATELY SUSPEND WORK AND NOTIFY THE HONOLULU POLICE DEPARTMENT, THE STATE DEPARTMENT OF LAND AND NATURAL RESOURCES--HISTORIC PRESERVATION DIVISION (692-8015). IN ADDITION, FOR NON-CITY PROJECTS, THE CONTRACTOR SHALL INFORM THE CIVIL ENGINEERING BRANCH, DEPARTMENT OF PLANNING AND PERMITTING (768-8084); AND FOR CITY PROJECTS, NOTIFY THE RESPONSIBLE CITY AGENCY.
- DURING NON-WORKING HOURS, THE TRENCHES ON CITY STREETS SHALL BE COVERED WITH NON-SKID STEEL PLATES AND ALL LANES MAINTAINED OPEN FOR TRAFFIC.
- ALL APPLICABLE CONSTRUCTION WORK SHALL BE DONE IN ACCORDANCE WITH THE STANDARD SPECIFICATIONS FOR PUBLIC WORKS CONSTRUCTION, SEPTEMBER 1986 AND STANDARD DETAILS FOR PUBLIC WORKS CONSTRUCTION, SEPTEMBER 1984, AS AMENDED, OF DEPARTMENT OF PUBLIC WORKS, CITY AND COUNTY OF HONOLULU AND THE COUNTIES OF KAUAI, MAUI, AND HAWAII.
- CONTRACTOR TO PROVIDE AS-BUILT DRAWINGS.
- FOR BENCH MARK, SEE DWG NOS. C-2, AND C-4.

NATIONAL DISCHARGE ELIMINATION SYSTEM (NPDES) REQUIREMENTS FOR PERMIT PROJECTS WITHIN STATE HIGHWAY RIGHT-OF-WAY

- THE CONTRACTOR SHALL OBTAIN AND COMPLY WITH THE NATIONAL POLLUTANT DISCHARGE ELIMINATION SYSTEM (NPDES) REQUIREMENTS FOR OAHU DISTRICT PERMIT PROJECTS. THIS IS AVAILABLE AT THE OAHU DISTRICT OFFICE AT 727 KAKOI STREET (PH. 831-6793). DUE TO POTENTIAL COST IMPACTS, THE CONTRACTOR NEEDS TO BE AWARE OF THESE REQUIREMENTS.
- THE CONTRACTOR SHALL COMPLETE AND SUBMIT A CONTRACTOR'S CERTIFICATION OF NPDES COMPLIANCE, INCLUDING COMPLETION OF THE BEST MANAGEMENT PRACTICE (BMP) CHECKLIST AND SUBMITTAL OF A WRITTEN BMP PLAN AND DRAWINGS, PRIOR TO ISSUANCE OF THE PERMIT TO PERFORM WORK UPON STATE HIGHWAYS. DUE TO POTENTIAL TIME IMPACTS ON REVIEWING BMPS, THE CONTRACTOR NEEDS TO ALLOW ENOUGH TIME FOR THE APPROVAL PROCESS.
- THE CONTRACTOR SHALL MEET APPLICABLE CONDITIONS DESCRIBED IN THE CURRENT HAWAII ADMINISTRATIVE RULES (HAR) CHAPTER 11-55. THE CONTRACTOR SHALL ALSO FOLLOW THE GUIDELINES IN THE CURRENT HIGHWAYS DIVISION'S "CONSTRUCTION BEST MANAGEMENT PRACTICES FIELD MANUAL" IN DEVELOPING, INSTALLING AND MAINTAINING THE BEST MANAGEMENT PRACTICES (BMPS) FOR THE PROJECT. IF THERE ARE ANY CONFLICTS BETWEEN THE TWO DOCUMENTS, THEN THE CONDITIONS IN THE HAR 11-55 SHALL GOVERN.
- THE CONTRACTOR SHALL FOLLOW THE GUIDELINES IN THE CITY AND COUNTY OF HONOLULU'S "RULES FOR SOIL EROSION STANDARDS AND GUIDELINES" FOR THE PROJECT.
- PLEASE BE ADVISED THAT NPDES REQUIREMENTS FOR PERMIT PROJECTS WITHIN STATE HIGHWAY RIGHT-OF-WAY ARE SUBJECT TO CHANGE WITHOUT PRIOR NOTICE.

DISABILITY AND COMMUNICATION ACCESS BOARD (DCAB) REQUIREMENTS

- WHERE PEDESTRIAN WALKWAYS EXIST, THEY SHALL BE MAINTAINED IN PASSABLE CONDITION OR OTHER FACILITIES FOR PEDESTRIANS SHALL BE PROVIDED. PASSAGE BETWEEN WALKWAYS AT INTERSECTIONS SHALL LIKEWISE BE PROVIDED. TEMPORARY PEDESTRIAN PASSAGES SHALL BE ACCESSIBLE PER ADAAG 201.3 AND SHALL COMPLY WITH ADAAG 206.1.

NOTES FOR CONSTRUCTION WITHIN STATE R/W

- THE CONTRACTOR SHALL OBTAIN A PERMIT TO PERFORM WORK UPON STATE HIGHWAYS FROM THE OAHU DISTRICT ENGINEER, STATE HIGHWAYS, AT 727 KAKOI STREET, PRIOR TO COMMENCEMENT OF WORK WITHIN THE STATE HIGHWAY RIGHT-OF-WAY.
- CONSTRUCTION AND RESTORATION OF ALL EXISTING HIGHWAY FACILITIES WITHIN THE STATE'S HIGHWAY RIGHT-OF-WAY, INCLUDING THE LEGAL RELATIONS AND RESPONSIBILITY TO THE PUBLIC, SHALL BE IN ACCORDANCE WITH THE CURRENT STANDARD SPECIFICATIONS FOR ROAD, BRIDGE AND PUBLIC WORKS CONSTRUCTION, AND THE SPECIFICATIONS FOR INSTALLATION OF MISCELLANEOUS IMPROVEMENTS WITHIN STATE HIGHWAYS, OF THE STATE HIGHWAYS DIVISION.

NOTES FOR CONSTRUCTION WITHIN STATE R/W (CONTINUED)

- WORK MAY BE PERFORMED BETWEEN THE HOURS OF 8:30 A.M. AND 3:00 P.M., MONDAY THROUGH FRIDAY, EXCEPT HOLIDAYS, AND "NO LANE CLOSURE" PERIODS, UNLESS OTHERWISE PERMITTED BY THE DISTRICT ENGINEER.

DURING WORK HOURS ONLY ONE LANE OF TRAFFIC SHALL BE CLOSED, UNLESS OTHERWISE APPROVED IN WRITING BY THE DISTRICT ENGINEER.

AT CERTAIN LOCATIONS, "NO LANE CLOSURE" WILL BE ALLOWED DURING THE "BACK TO SCHOOL JAM", THANKSGIVING WEEKEND, CHRISTMAS/NEW YEAR PERIOD AND AT OTHER TIMES AS DIRECTED BY THE HIGHWAYS DIVISION.
- THE CONTRACTOR SHALL PROVIDE, INSTALL, AND MAINTAIN ALL NECESSARY SIGNS, LIGHTS, FLARES, BARRICADES, MARKERS, CONES, AND OTHER PROTECTIVE FACILITIES, AND SHALL TAKE ALL NECESSARY PRECAUTIONS FOR THE PROTECTION, CONVENIENCE, AND SAFETY OF PUBLIC TRAFFIC. ALL SUCH PROTECTIVE FACILITIES AND RECAUTIONS TO BE TAKEN SHALL CONFORM WITH THE "ADMINISTRATIVE RULES OF HAWAII GOVERNING THE USE OF TRAFFIC CONTROL DEVICES AT WORK SITES ON OR ADJACENT TO PUBLIC STREETS AND HIGHWAYS", ADOPTED BY THE DIRECTOR OF TRANSPORTATION, AND THE "U.S. FEDERAL HIGHWAY ADMINISTRATION MUTCD - MANUAL ON UNIFORM TRAFFIC CONTROL DEVICES, PART VI - TEMPORARY TRAFFIC CONTROL."
- LANE CLOSURES SHALL CONFORM TO THE TRAFFIC CONTROL PLAN INCORPORATED INTO THESE CONSTRUCTION PLANS AND MUST BE APPROVED BY THE DIVISION PRIOR TO THE ISSUANCE OF THE PERMIT.
- THE MINIMUM PAVEMENT STRUCTURE SHALL CONSIST OF:

A. RESIDENTIAL DRIVEWAYS, ON MINOR HIGHWAYS:

(1) 2-1/2" ASPHALT CONCRETE (MIX IV), 6" AGGREGATE BASE COURSE AND 12" SUBBASE, OR 2-1/2" ASPHALT CONCRETE AND 6" ASPHALT CONCRETE BASE COURSE.

(2) 6" OF CLASS "A" CONCRETE REINFORCED WITH 6"x6" - W2.9 X W2.9 WIRE MESH ON 12" AGGREGATE SUBBASE, IF DEEMED NECESSARY BY THE ENGINEER.

B. COMMERCIAL DRIVEWAYS AND SIDEROADS ON MINOR HIGHWAYS

(1) 2-1/2" ASPHALT CONCRETE (MIX IV), 6" ASPHALT CONCRETE BASE COURSE AND 12" SUBBASE, OR 4" ASPHALT CONCRETE (MIX IV) AND 8" ASPHALT CONCRETE BASE COURSE.

(2) 8" OF CLASS "A" CONCRETE REINFORCED WITH 6"x6" - W2.9 X W2.9 WIRE MESH ON 12" AGGREGATE SUBBASE, IF DEEMED NECESSARY BY THE ENGINEER.

C. CHANNELIZED INTERSECTIONS ON MAJOR HIGHWAYS:

4" ASPHALT CONCRETE (MIX IV), 8" ASPHALT CONCRETE BASE COURSE AND 12" AGGREGATE SUBBASE, OR 4" ASPHALT CONCRETE (MIX IV) AND 12" ASPHALT CONCRETE BASE COURSE.
- NO MATERIAL AND/OR EQUIPMENT SHALL BE STOCKPILED OR OTHERWISE STORED WITHIN THE HIGHWAY RIGHT-OF-WAY, EXCEPT AT LOCATIONS DESIGNATED IN WRITING AND APPROVED BY THE DISTRICT ENGINEER.
- COMPACTION TESTS SHALL BE TAKEN IN ACCORDANCE WITH THE SPECIFICATIONS FOR INSTALLATION OF MISCELLANEOUS IMPROVEMENTS WITHIN STATE HIGHWAYS, AS FOLLOWS:

A. SUBBASE: ONE (1) COMPACTION TEST PER LIFT PER 200 LINEAL FEET OF ROADWAY.

B. BASE COURSE: ONE (1) COMPACTION TEST PER LIFT PER 200 LINEAL FEET OF ROADWAY.

C. ONE (1) COMPACTION TEST PER LIFT PER 300 LINEAL FEET OF TRENCH.

D. A COPY OF THE TEST RESULTS SHALL BE SUBMITTED TO THE DISTRICT ENGINEER.
- THE CONTRACTOR SHALL TAKE A PROFILE ALONG THE CENTERLINE OF THE PROPOSED UTILITY TRENCH BOTH BEFORE COMMENCING TRENCH EXCAVATION WORK AND AFTER TRENCH HAS BEEN REPAVED. PROFILES SHALL BE SUBMITTED TO THE DISTRICT ENGINEER AND SHALL BE USED TO VERIFY THE ROADWAY SURFACE HAS BEEN RESTORED TO ITS ORIGINAL CONDITION OR SMOOTHER.
- THE DISTANCE FROM THE PAVED SURFACE TO THE TESTING EDGE OF A TEN-FOOT LONG STRAIGHT EDGE BETWEEN TWO POINTS SHALL NOT EXCEED 3/16 INCH.
- THE CONTRACTOR SHALL PROVIDE AN ADEQUATE AND SAFE NON-SKID BRIDGING MATERIAL, INCLUDING SHORING, OVER TRENCHES IN PAVEMENT AREAS. THE BRIDGING SHALL BE ABLE TO SUPPORT ALL TYPES OF VEHICULAR TRAFFIC. BRIDGING MATERIALS SHALL NOT BE USED ON HIGH SPEED ROADWAYS, WHICH ARE ROADS WITH A DESIGN SPEED OF 50 MPH OR HIGHER. SMOOTH RIDING CONNECTION BETWEEN ROADWAY SURFACES AND BRIDGING MATERIAL SHALL BE PROVIDED. SHOULD COMPLAINTS BE RECEIVED DUE TO NOISE GENERATED FROM THIS WORK, THE CONTRACTOR SHALL IMMEDIATELY ADDRESS THOSE COMPLAINTS.
- THE CONTRACTOR SHALL MAKE EVERY EFFORT TO MINIMIZE THE USE AND THE DURATION OF USE OF BRIDGING MATERIALS. THE STATE MAY REQUIRE THE BACKFILLING AND PATCHES OF TRENCHES DUE TO THE EXCESSIVE USAGE OF STEEL PLATES.
- UNLESS OTHERWISE NOTED, NO TRENCH SHALL BE OPENED MORE THAN 300 FEET IN ADVANCE OF INSTALLED AND TESTED PIPELINE AND/OR DUCTLINE.
- EXISTING DRAINAGE SYSTEMS SHALL BE FUNCTIONAL AT ALL TIMES.
- THE CONTRACTOR SHALL EXERCISE CARE TO MINIMIZE DAMAGES TO EXISTING HIGHWAY IMPROVEMENTS. ALL DAMAGES SHALL BE REPAIRED BY THE CONTRACTOR, AT HIS EXPENSE, TO THE SATISFACTION OF THE DISTRICT ENGINEER.
- APPROVAL OF PERMIT CONSTRUCTION PLANS SHALL BE VALID FOR A PERIOD OF ONE (1) YEAR FROM THE DATE OF NOTIFICATION OF APPROVAL TO THE APPLICANT. IN THE EVENT CONSTRUCTION DOES NOT COMMENCE WITHIN THIS ONE-YEAR PERIOD, THE APPLICANT WILL BE REQUIRED TO RESUBMIT THE CONSTRUCTION PLANS FOR THE DIVISION'S REVIEW AND RE-APPROVAL.
- ALL REGULATORY, GUIDE, AND CONSTRUCTION SIGNS AND BARRICADES SHALL HAVE A HIGH-INTENSITY TYPE III OR IV RETROREFLECTIVE BACKGROUND.
- THE CONTRACTOR SHALL INFORM THE STATE HIGHWAY'S PERMIT OFFICE (831-6712) AT LEAST TWO (2) WEEKS PRIOR TO CLOSING ANY LANES.
- DRIVEWAYS SHALL BE KEPT OPEN UNLESS THE OWNERS OF THE PROPERTIES USING THESE RIGHTS-OF-WAY ARE OTHERWISE PROVIDED FOR SATISFACTORILY.
- WHERE PEDESTRIAN WALKWAYS EXIST THEY SHALL BE MAINTAINED IN A SAFE AND PASSABLE CONDITION, OR OTHER FACILITIES FOR PEDESTRIANS SHALL BE PROVIDED. PASSAGES BETWEEN WALKWAYS AT INTERSECTIONS SHALL LIKEWISE BE PROVIDED. ALL WALKWAYS SHALL CONFORM TO ADA REQUIREMENTS.

NOTES FOR CONSTRUCTION WITHIN STATE R/W (CONTINUED)

- THE CONTRACTOR SHALL REFERENCE, TO THE SATISFACTION OF THE DISTRICT ENGINEER, ALL EXISTING TRAFFIC SIGNS, POSTS, AND PAVEMENT MARKINGS PRIOR TO THE COMMENCEMENT OF CONSTRUCTION. THE CONTRACTOR SHALL REPLACE OR REPAIR ALL TRAFFIC SIGNS, POSTS, AND PAVEMENT MARKINGS DISTURBED BY HIS ACTIVITIES, AT HIS EXPENSE, UNLESS DIRECTED BY THE DISTRICT ENGINEER OR HIS REPRESENTATIVE.
- THE CONTRACTOR SHALL EXERCISE CARE WHEN PERFORMING WORK IN OR ADJACENT TO THE STATE HIGHWAY RIGHT-OF-WAY. DAMAGES TO THE EXISTING FACILITIES SHALL BE IMMEDIATELY REPORTED TO THE RESPECTIVE UTILITY COMPANIES, AND/OR CITY OR STATE AGENCIES. THE REPAIR WORK SHALL BE DONE AT THE CONTRACTOR'S EXPENSE.
- HIGHWAY LIGHTS SHALL BE KEPT OPERATIONAL DURING CONSTRUCTION. SHOULD WORK BE NECESSARY, THE CONTRACTOR SHALL NOTIFY THE STATE HIGHWAY'S HIGHWAY LIGHTING SUPERVISOR (837-8056), THREE (3) WORKING DAYS PRIOR TO COMMENCING WORK.
- THE CONTRACTOR SHALL NOTIFY THE CITY DEPARTMENT OF TRANSPORTATION SERVICES, TRAFFIC SIGNAL ENGINEER (768-8388), THREE (3) DAYS PRIOR TO ANY SIGNALIZED INTERSECTION WORK.
- TRAFFIC SIGNALS SHALL BE KEPT OPERATIONAL DURING CONSTRUCTION. TEMPORARY OPERATIONAL MICROWAVE OR OTHER APPROVED DETECTION DEVICES SHALL BE INSTALLED THREE (3) WORKING DAYS PRIOR TO ANY SIGNALIZED INTERSECTION EXCAVATION WORK. ALL WORK SHALL BE DONE IN ACCORDANCE TO THE REQUIREMENTS OF THE DEPARTMENT OF TRANSPORTATION SERVICES, CITY AND COUNTY OF HONOLULU, AND PAID FOR BY THE CONTRACTOR.
- THE CONTRACTOR SHALL NOTIFY THE DEPARTMENT OF TRANSPORTATION SERVICES, PUBLIC TRANSIT DIVISION AT 768-8396 AND OAHU TRANSIT SERVICES, INC. (BUS OPERATIONS: 848-4578 OR 852-6016 AND PARA-TRANSIT OPERATIONS: 454-5041 OR 454-5020) TWO(2) WEEKS PRIOR TO COMMENCING ANY WORK. THE CONTRACTOR SHALL INFORM OF THE LOCATION AND SCOPE OF WORK, PROPOSED CLOSURE OF ANY STREET OR TRAFFIC LANES, AND THE NEED TO RELOCATE ANY BUS STOP.
- THE PERMIT TO PERFORM WORK UPON STATE HIGHWAY MAY BE REVOKED BECAUSE OF DEFAULT IN ANY OF THE FOLLOWING, BUT NOT LIMITED TO, CONDITIONS:

A. WORK PERFORMED BEFORE OR AFTER PERMITTED HOURS.

B. FAILURE TO MAINTAIN ROADWAY SURFACES IN A SMOOTH AND SAFE CONDITION.

C. FAILURE TO CLEAN UP CONSTRUCTION DEBRIS GENERATED FROM PROJECT WORK.

D. FAILURE TO PROVIDE PROPER TRAFFIC CONTROL.

E. FAILURE TO REPLACE DAMAGED PAVEMENT MARKINGS AND SIGNS.

F. FAILURE TO MAINTAIN HIGHWAY LIGHTS AND/OR TRAFFIC SIGNAL SYSTEMS.

G. FAILURE TO ADDRESS PUBLIC COMPLAINTS TO THE SATISFACTION OF THE DISTRICT ENGINEER.
- THE CONTRACTOR SHALL NOTIFY THE STATE HIGHWAYS PERMIT OFFICE (831-6712) AT LEAST TWO DAYS PRIOR TO PERFORMING ANY TRENCH RESTORATION WORK. THIS WORK SHALL INCLUDE ANY BACKFILLING AND COMPACTING OF TRENCH MATERIAL; ANY PLACING AND COMPACTING OF BASE COURSE MATERIAL; AND ANY PAVING OPERATIONS. ANY TRENCH RESTORATION WORK PERFORMED BY THE CONTRACTOR THAT IS NOT WITNESSED BY A STATE REPRESENTATIVE WILL BE REQUIRED TO BE REMOVED AND RESTORED WITH A STATE REPRESENTATIVE PRESENT. ALL RESTORATION WORK WILL BE AT THE CONTRACTOR'S EXPENSE.
- TEMPORARY COLD MIX TRENCH PATCHES WILL BE PERMITTED IN ANY GIVEN AREA FOR A MAXIMUM DURATION OF TWO(2) WEEKS, AND SHALL BE A MINIMUM OF 2 INCHES THICK. ALL TEMPORARY PATCHES SHALL BE PLACED OVER PROPERLY PLACED AND COMPACTED BACKFILL AND BASE COURSE. CONTRACTOR SHALL BE RESPONSIBLE FOR MAINTAINING ALL TEMPORARY PATCHES AND TO MAKE REPAIRS TO UNSATISFACTORY PATCHES WITHIN 24 HOURS.
- PLASTIC MARKING TAPE. PROVIDE PLASTIC MARKING TAPE THAT IS ACID AND ALKALI RESISTANT POLYETHYLENE FILM 6 INCHES WIDE WITH MINIMUM THICKNESS OF 0.004 INCH. PROVIDE TAPE WITH MINIMUM STRENGTH OF 1750 PSI LENGTHWISE AND 1500 PSI CROSSWISE. MANUFACTURE TAPE WITH INTEGRAL WIRES, FOIL BACKING OR OTHER MEANS TO ENABLE DETECTION BY A METAL DETECTOR WHEN THE TAPE IS BURIED UP TO 3 FEET DEEP. MANUFACTURE TAPE SPECIFICALLY FOR MARKING AND LOCATING UNDERGROUND UTILITIES. PROVIDE THE METALLIC CORE OF THE TAPE ENCASED IN A PROTECTIVE JACKET OR PROVIDED WITH OTHER MEANS TO PROTECT IT FROM CORROSION. CONFORM TO THE FOLLOWING TAPE COLOR AND BEAR A CONTINUOUS PRINTED INSCRIPTION DESCRIBING THE SPECIFIC UTILITY.

RED: ELECTRIC

YELLOW: GAS, OIL, DANGEROUS MATERIALS

ORANGE: TELEPHONE, TELEGRAPH, TELEVISION, POLICE, AND FIRE COMMUNICATIONS

BLUE: WATER SYSTEMS

GREEN: SEWER SYSTEMS
- THE CONTRACTOR SHALL PROVIDE THE DISTRICT ENGINEER WITH AS-BUILT PLANS UPON COMPLETION OF THE WORK DONE IN THE STATE RIGHT-OF-WAY. THIS SHALL BE DONE PRIOR TO THE DEPARTMENT'S RELEASE OF THE PERFORMANCE BOND.

CONSTRUCTION BMPS

- THE FOLLOWING SPECIAL CONDITIONS APPLY TO ALL LAND DISTURBANCE WORK CONDUCTED UNDER THE GENERAL PERMIT:

A. CONSTRUCTION MANAGEMENT TECHNIQUES INCLUDE:

1. CLEARING AND GRUBBING SHALL BE HELD TO THE MINIMUM NECESSARY FOR GRADING AND EQUIPMENT OPERATION.

2. EROSION AND SEDIMENT CONTROL MEASURES SHALL BE IN PLACE AND FUNCTIONAL BEFORE EARTH MOVING OPERATIONS BEGIN AND SHALL BE CONSTRUCTED AND MAINTAINED THROUGHOUT THE CONSTRUCTION PERIOD. TEMPORARY MEASURES MAY BE REMOVED AT THE BEGINNING OF THE WORK DAY, BUT SHALL BE REPLACED AT THE END OF THE WORK DAY.

3. ALL CONTROL MEASURES SHALL BE CHECKED AND REPAIRED AS NECESSARY, OR WEEKLY IN DRY PERIODS. DAILY CHECKING WITHIN 24-HOUR PERIOD IS NECESSARY DURING PROLONGED RAINFALL. THE PERMITTEE SHALL MAINTAIN RECORDS OF CHECKS AND REPAIRS.

4. A SPECIFIC INDIVIDUAL SHALL BE DESIGNATED TO BE RESPONSIBLE FOR EROSION AND SEDIMENT CONTROLS ON EACH PROJECT SITE.

B. VEGETATION CONTROLS INCLUDE:

1. PRE-CONSTRUCTION VEGETATIVE GROUND OR MULCH COVER SHALL NOT BE DESTROYED, REMOVED OR DISTURBED MORE THAN 20 CALENDAR DAYS PRIOR TO SITE DISTURBANCE.

2. TEMPORARY SOIL STABILIZATION WITH APPROPRIATE VEGETATION OR MULCH SHALL BE APPLIED ON AREAS THAT WILL REMAIN UNFINISHED FOR MORE THAN 30 CALENDAR DAYS.

3. PERMANENT SOIL STABILIZATION WITH PERENNIAL VEGETATION SHALL BE APPLIED AS SOON AS PRACTICABLE AFTER FINAL GRADING.

CONSTRUCTION BMPS (CONTINUED)

- C. STRUCTURAL CONTROLS INCLUDE:
- ALL SURFACE WATER FLOWING TOWARD THE CONSTRUCTION AREA SHALL BE DIVERTED BY USING BERMS, CHANNELS, SEDIMENT TRAPS, AND OTHER APPROPRIATE CONTROL MEASURES, AS PRACTICAL.
 - EROSION CONTROL MEASURES SHALL BE DESIGNED ACCORDING TO THE SIZE OF DISTURBED OR DRAINAGE AREAS, TO DETAIN RUNOFF AND TRAP SEDIMENT.
 - WATER MUST BE DISCHARGED THROUGH A PIPE OR LINED CHANNEL SO THAT THE DISCHARGE DOES NOT CAUSE EROSION.
 - STORM DRAIN INLET PROTECTION.
- D. EROSION CONTROLS / BEST MANAGEMENT PRACTICE INCLUDE:
- GOOD HOUSEKEEPING SHALL BE UTILIZED TO ENSURE PROTECTION OF ROADWAYS FROM MUD, DIRT, AND DEBRIS.
 - THE CONTRACTOR SHALL ENSURE THAT ALL TIRES OF CONSTRUCTION VEHICLES ARE SUFFICIENTLY CLEANED OFF SO THAT DIRT OR DEBRIS IS NOT TRACKED OFF THE CONSTRUCTION SITE. WASHING OFF TIRES WITH WATER WILL NOT BE ACCEPTABLE UNLESS THE RUNOFF IS CONTAINED AND DOES NOT ENTER THE STORM DRAIN SYSTEM OR ONTO THE ROADWAY.
 - AT THE END OF GRADING OPERATIONS AND AT THE COMPLETION OF PROJECT, CONTRACTOR SHALL INSPECT ALL CATCH BASIN, DRAIN INLET AND DRAIN MANHOLE SURROUNDING THE PROJECT SITE. ANY ACCUMULATED SEDIMENT AND DEBRIS FOUND IN THE STORM DRAIN STRUCTURES SHALL BE REMOVED. PLEASE NOTE THAT FLUSHING INTO THE DRAIN STRUCTURES ARE PROHIBITED.
 - ANY DIRT OR GRASSED AREA DISTURBED SHALL BE RESTORED BY RE-GRASSING THE AREA OR BY SEEDED HYDROMULCH. THE GRASS SHALL BE FULLY ESTABLISHED AT COMPLETION OF PROJECT.

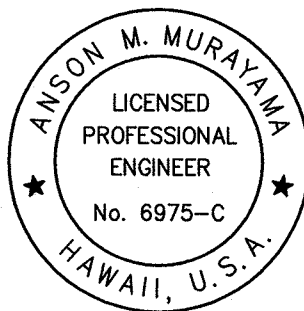

THIS WORK WAS PREPARED BY ME OR UNDER MY SUPERVISION. CONSTRUCTION OF THIS PROJECT WILL BE UNDER MY OBSERVATION. LICENSE EXPIRATION DATE: 04/30/20

REVISION DATE	DESCRIPTION	MADE BY	APPROVED
Community Planning and Engineering, Inc. Engineering Design Construction Management Infrastructure Planning 1286 Queen Emma Street Honolulu, Hawaii			
KANEHILI PEDESTRIAN ACCESS HONOLULU, EWA, OAHU, HAWAII OWNER AND DEVELOPER: DEPARTMENT OF TRANSPORTATION DEPARTMENT OF HAWAIIAN HOME LANDS TAX MAP KEY: 9-1-017:096, 9-1-151:001, 9-1-152:160, 9-1-153:194			
CONSTRUCTION NOTES			
DRAWN BY: HHW	ENGINEER: SS, HHW	CHECKED BY: AM	
APPROVED:			
FILE	POCKET	FOLDER	NO.

NOTES :

- 1875± LIN. FT. OF CHAIN-LINK MESH FABRIC TO BE PROVIDED BY DHHL. CONTRACTOR SHALL COORDINATE WITH DHHL FOR LOCATION, AVAILABILITY, AND TRANSPORTATION OF THE MATERIAL.
- EXISTING DRAIN INLET SHALL BE MAINTAINED AND FULLY FUNCTIONAL DURING AND AFTER CONSTRUCTION. CONTRACTOR SHALL VERIFY LOCATION AND DEPTH OF EXISTING DRAINAGE SYSTEM, AND NOT DAMAGE OR ALTER ANY DRAINAGE STRUCTURES.

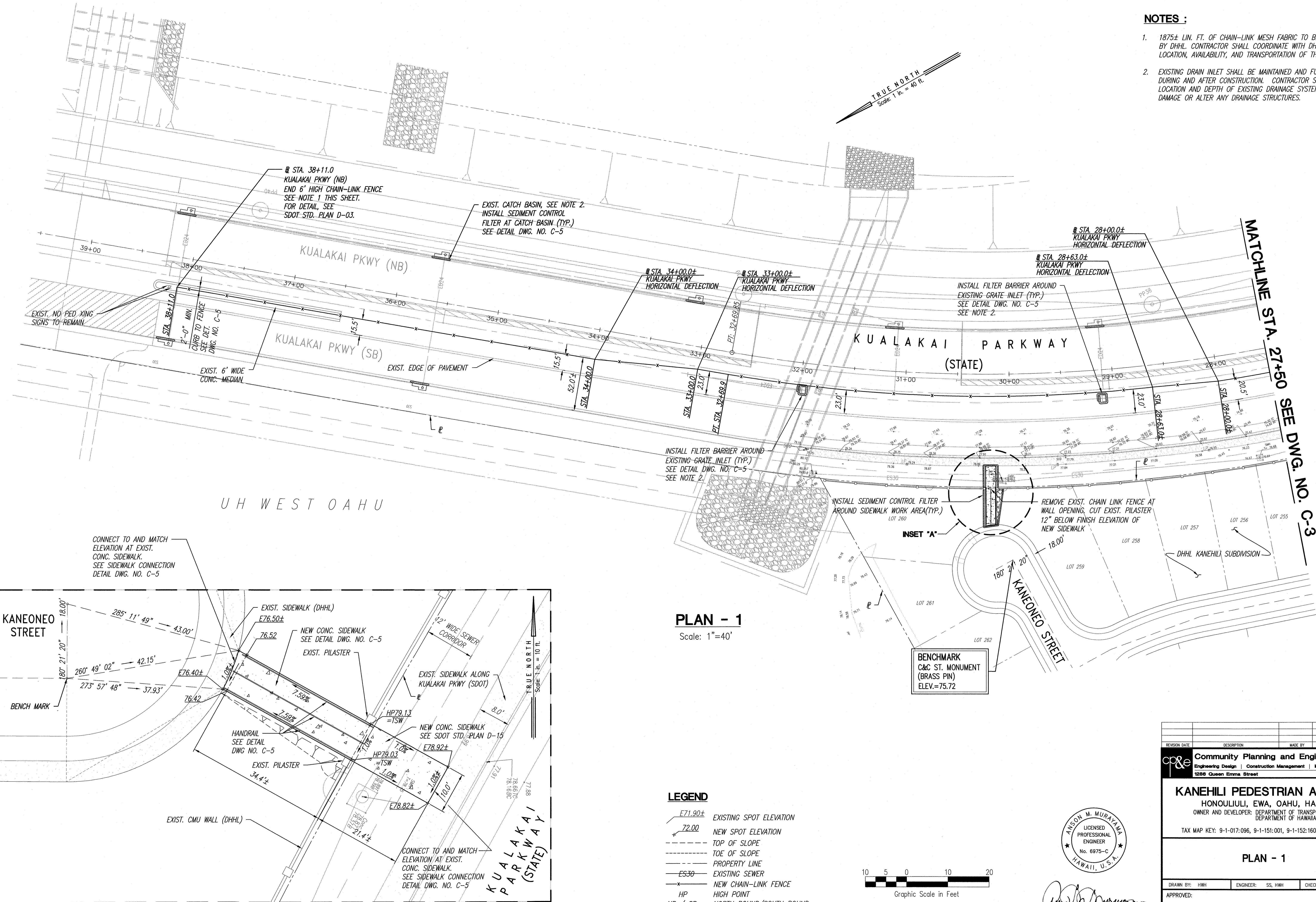

PLAN - 1

Scale: 1"=40'

LEGEND

- E71.90± EXISTING SPOT ELEVATION
- 72.00 NEW SPOT ELEVATION
- TOP OF SLOPE
- TOE OF SLOPE
- PROPERTY LINE
- EXISTING SEWER
- NEW CHAIN-LINK FENCE
- HP HIGH POINT
- NB / SB NORTH BOUND/SOUTH BOUND
- SEDIMENT CONTROL FILTER
- TSW TOP SIDEWALK

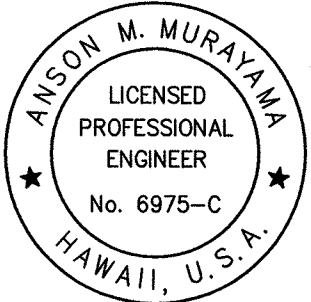
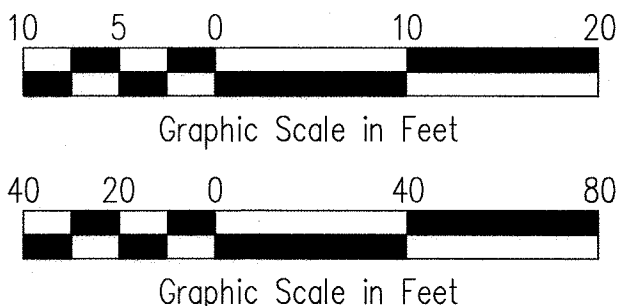

THIS WORK WAS PREPARED BY ME OR UNDER MY SUPERVISION. CONSTRUCTION OF THIS PROJECT WILL BE UNDER MY OBSERVATION. LICENSE EXPIRATION DATE: 04/30/20

REVISION DATE	DESCRIPTION	MADE BY	APPROVED
Community Planning and Engineering, Inc. Engineering Design Construction Management Infrastructure Planning 1286 Queen Emma Street Honolulu, Hawaii			
KANEHILI PEDESTRIAN ACCESS HONOLULU, EWA, OAHU, HAWAII OWNER AND DEVELOPER: DEPARTMENT OF TRANSPORTATION DEPARTMENT OF HAWAIIAN HOME LANDS TAX MAP KEY: 9-1-017:096, 9-1-151:001, 9-1-152:160, 9-1-153:194			
PLAN - 1			
DRAWN BY: HHW	ENGINEER: SS, HHW	CHECKED BY: AM	APPROVED:

MATCHLINE STA. 27+50 SEE DWG. NO. C-2

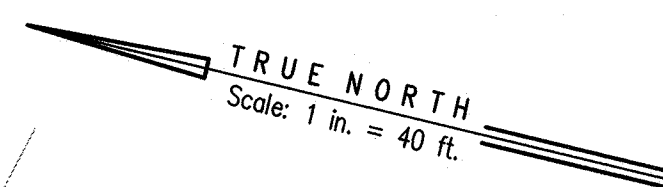

INSTALL FILTER BARRIER AROUND EXISTING GRATE INLET (TYP.) SEE DETAIL DWG. NO. C-5 SEE NOTE 2.

EXIST. CATCH BASIN, SEE NOTE 2. INSTALL SEDIMENT CONTROL FILTER AT CATCH BASIN (TYP.) SEE DETAIL DWG. NO. C-5

INSTALL FILTER BARRIER AROUND EXISTING GRATE INLET (TYP.) SEE DETAIL DWG. NO. C-5 SEE NOTE 2.

INSTALL FILTER BARRIER AROUND EXISTING GRATE INLET (TYP.) SEE DETAIL DWG. NO. C-5 SEE NOTE 2.

REMOVE EXIST. CHAIN LINK FENCE AT WALL OPENING. CUT EXIST. POST 12" BELOW FINISH ELEVATION OF NEW SIDEWALK

INSET "B"
INSTALL SEDIMENT CONTROL FILTER AROUND SIDEWALK WORK AREA (TYP.)

BENCHMARK
C&C ST. MONUMENT
(BRASS PIN)
ELEV.=71.08

PLAN - 2
Scale: 1"=40'

NOTES :

- 1875± LIN. FT. OF CHAIN-LINK MESH FABRIC TO BE PROVIDED BY DHHL. CONTRACTOR SHALL COORDINATE WITH DHHL FOR LOCATION, AVAILABILITY, AND TRANSPORTATION OF THE MATERIAL.
- EXISTING DRAIN INLET SHALL BE MAINTAINED AND FULLY FUNCTIONAL DURING AND AFTER CONSTRUCTION. CONTRACTOR SHALL VERIFY LOCATION AND DEPTH OF EXISTING DRAINAGE SYSTEM, AND NOT DAMAGE OR ALTER ANY DRAINAGE STRUCTURES.

LEGEND

- E71.90± EXISTING SPOT ELEVATION
- 72.00 NEW SPOT ELEVATION
- TOP OF SLOPE
- TOE OF SLOPE
- PROPERTY LINE
- ES30 EXISTING SEWER
- NEW CHAIN-LINK FENCE
- HP HIGH POINT
- NB / SB NORTH BOUND/SOUTH BOUND
- SEDIMENT CONTROL FILTER
- TSW TOP SIDEWALK

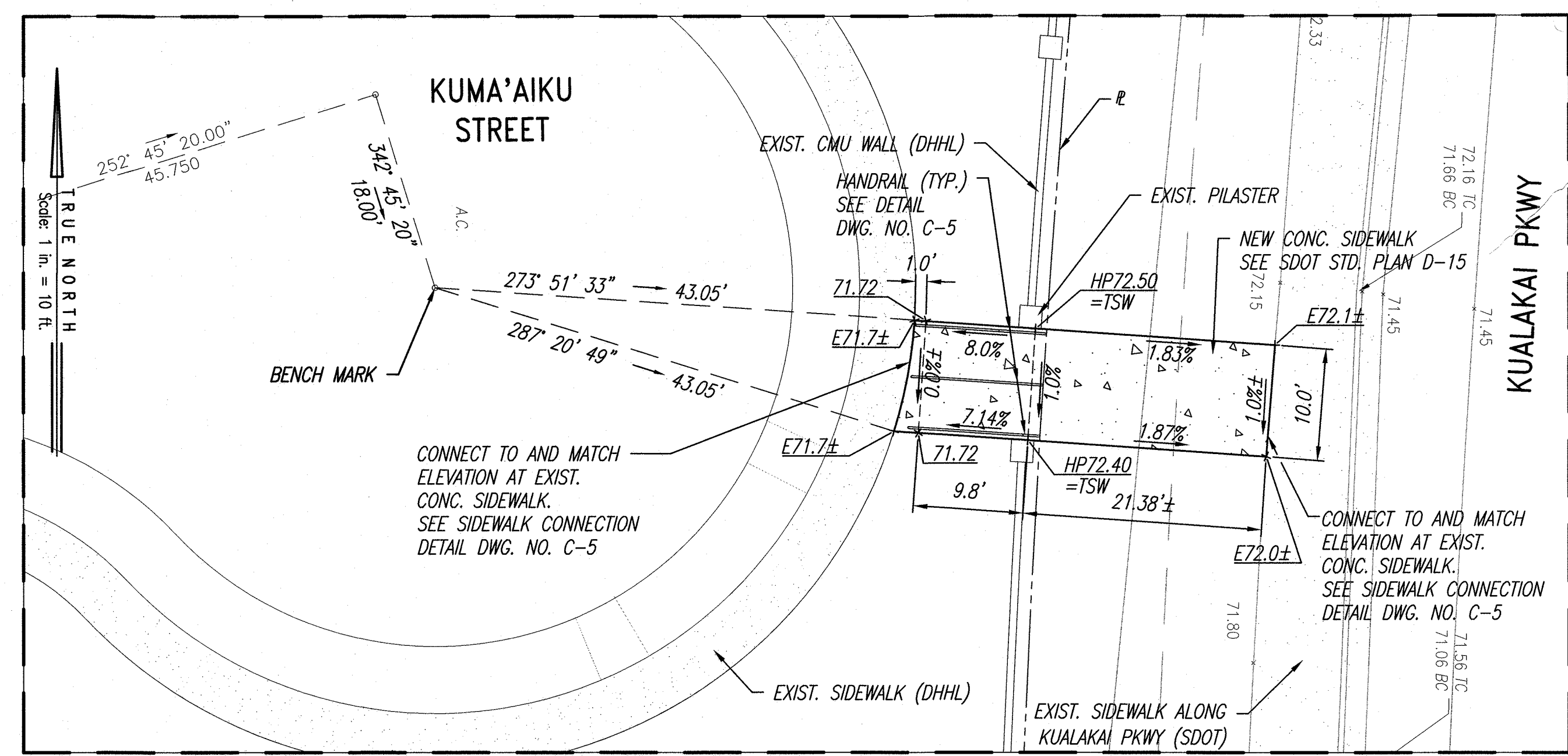

INSET "B"
Scale: 1"=10'

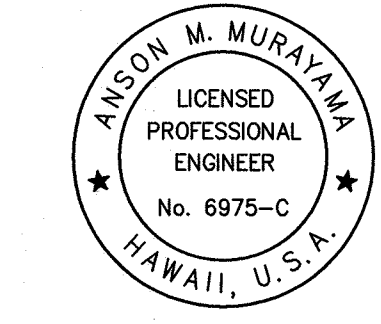
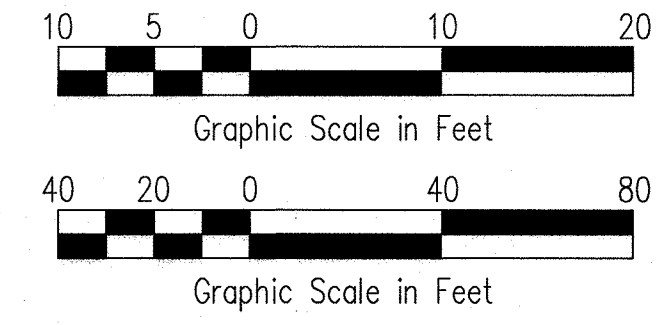

THIS WORK WAS PREPARED BY ME OR UNDER MY SUPERVISION. CONSTRUCTION OF THIS PROJECT WILL BE UNDER MY OBSERVATION. LICENSE EXPIRATION DATE: 04/30/20

REVISION DATE	DESCRIPTION	MADE BY	APPROVED
Community Planning and Engineering, Inc. Engineering Design Construction Management Infrastructure Planning 1286 Queen Emma Street Honolulu, Hawaii			
KANEHILI PEDESTRIAN ACCESS HONOLULU, EWA, OAHU, HAWAII OWNER AND DEVELOPER: DEPARTMENT OF TRANSPORTATION DEPARTMENT OF HAWAIIAN HOME LANDS TAX MAP KEY: 9-1-017:096, 9-1-151:001, 9-1-152:160, 9-1-153:194			
PLAN - 2			
DRAWN BY: HWH	ENGINEER: SS, HWH	CHECKED BY: AM	APPROVED:

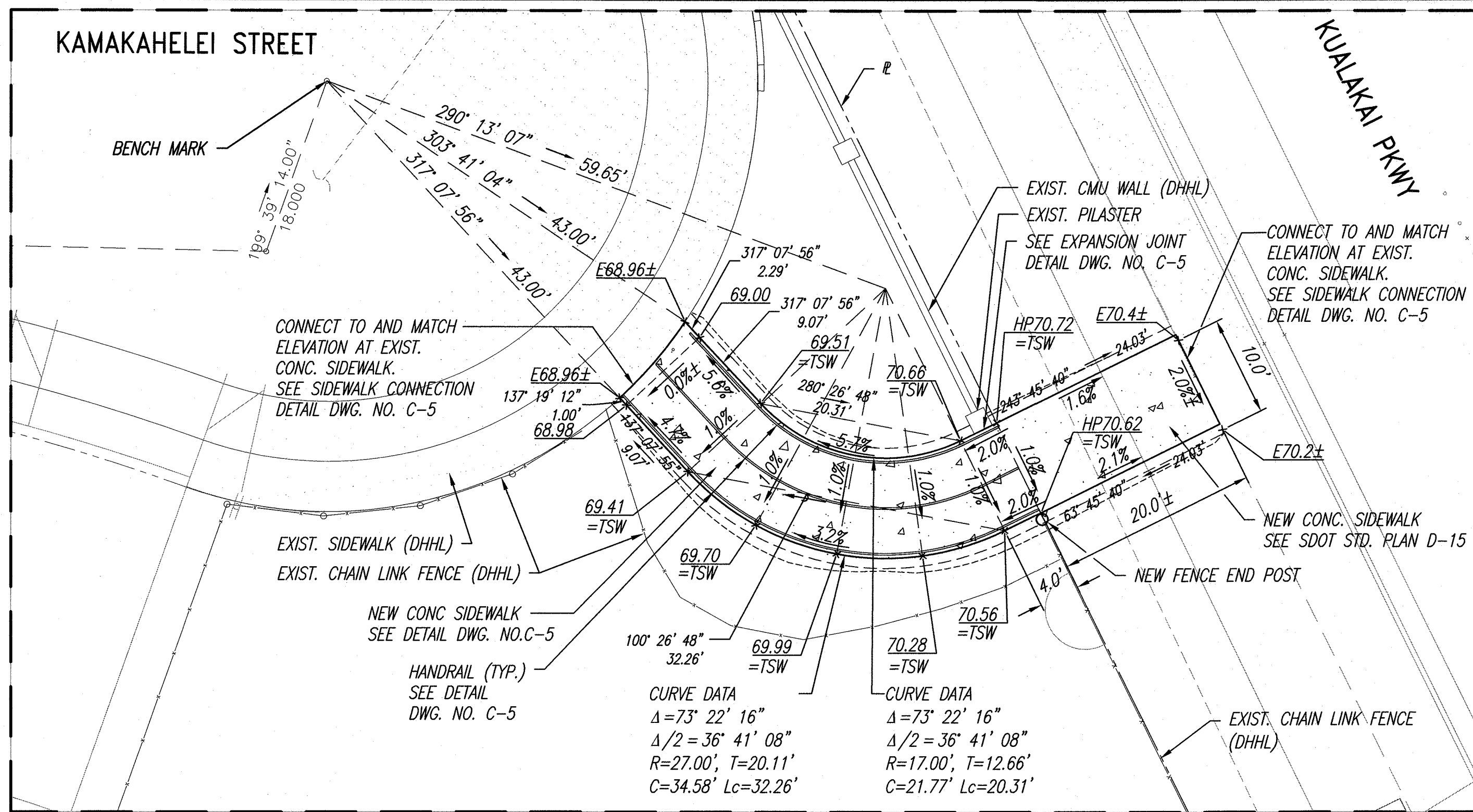

INSET "C"
Scale: 1"=10'

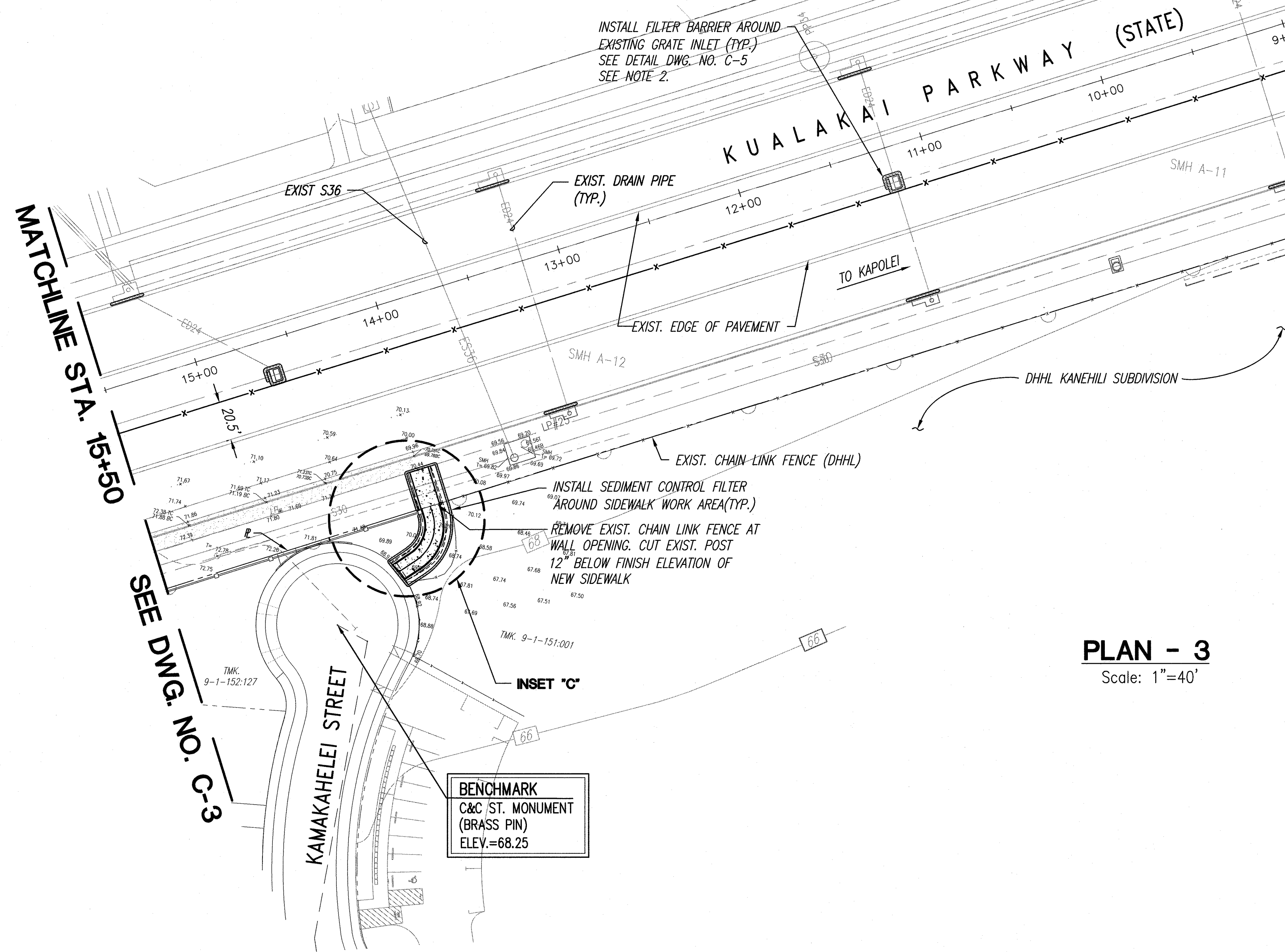

PLAN - 3
Scale: 1"=40'

INSTALL FILTER BARRIER AROUND EXISTING GRATE INLET (TYP.) SEE DETAIL DWG. NO. C-5 SEE NOTE 2.

STA. 7+50.0± KUALAKAI PKWY HORIZONTAL DEFLECTION

STA. 8+00.0± KUALAKAI PKWY HORIZONTAL DEFLECTION

EXIST. CATCH BASIN SEE NOTE 2. INSTALL SEDIMENT CONTROL FILTER AT CATCH BASIN (TYP.) SEE DETAIL DWG. NO. C-5

TRUE NORTH
Scale: 1 in. = 40 ft.

INSTALL SIGNS EACH SIDE SEE NOTE 3



R9-3/R9-3a
18"x18" (2EA)
18"x12" (2EA)

STA. 5+50.0± KUALAKAI PKWY (NB) BEGIN 6' HIGH CHAIN-LINK FENCE SEE NOTE 1 THIS SHEET. FOR DETAIL, SEE SDOT STD. PLAN D-03.

NOTES :

- 1875± LIN. FT. OF CHAIN-LINK MESH FABRIC TO BE PROVIDED BY DHHL. CONTRACTOR SHALL COORDINATE WITH DHHL FOR LOCATION, AVAILABILITY, AND TRANSPORTATION OF THE MATERIAL.
- EXISTING DRAIN INLET SHALL BE MAINTAINED AND FULLY FUNCTIONAL DURING AND AFTER CONSTRUCTION. CONTRACTOR SHALL VERIFY LOCATION AND DEPTH OF EXISTING DRAINAGE SYSTEM, AND NOT DAMAGE OR ALTER ANY DRAINAGE STRUCTURES.
- INSTALL SIGNS ON A NEW SIGN POST ON EACH SIDE OF FENCE PER DOT STANDARDS.

LEGEND

- E71.90± EXISTING SPOT ELEVATION
- 72.00 NEW SPOT ELEVATION
- TOP OF SLOPE
- TOE OF SLOPE
- PROPERTY LINE
- EXISTING SEWER
- NEW CHAIN-LINK FENCE
- HP HIGH POINT
- NB / SB NORTH BOUND/SOUTH BOUND
- SEDIMENT CONTROL FILTER
- TSW TOP SIDEWALK

REVISION DATE	DESCRIPTION	MADE BY	APPROVED

Community Planning and Engineering, Inc.
Engineering Design | Construction Management | Infrastructure Planning
1288 Queen Emma Street Honolulu, Hawaii

KANEHILI PEDESTRIAN ACCESS

HONOLULU, EWA, OAHU, HAWAII
OWNER AND DEVELOPER: DEPARTMENT OF TRANSPORTATION
DEPARTMENT OF HAWAIIAN HOME LANDS

TAX MAP KEY: 9-1-017:096, 9-1-151:001, 9-1-152:160, 9-1-153:194

PLAN - 3

DRAWN BY: HWH ENGINEER: SS, HWH CHECKED BY: AM

APPROVED:

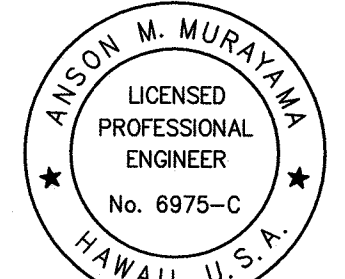

THIS WORK WAS PREPARED BY ME OR UNDER MY SUPERVISION. CONSTRUCTION OF THIS PROJECT WILL BE UNDER MY OBSERVATION. LICENSE EXPIRATION DATE: 04/30/20

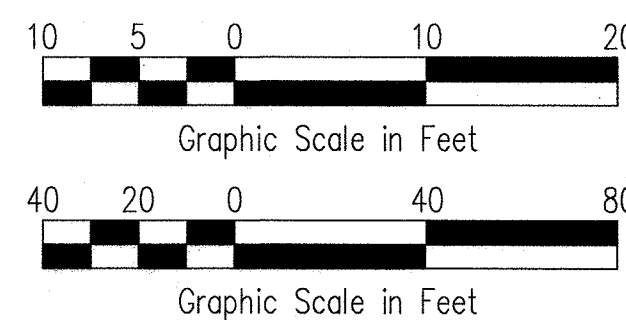

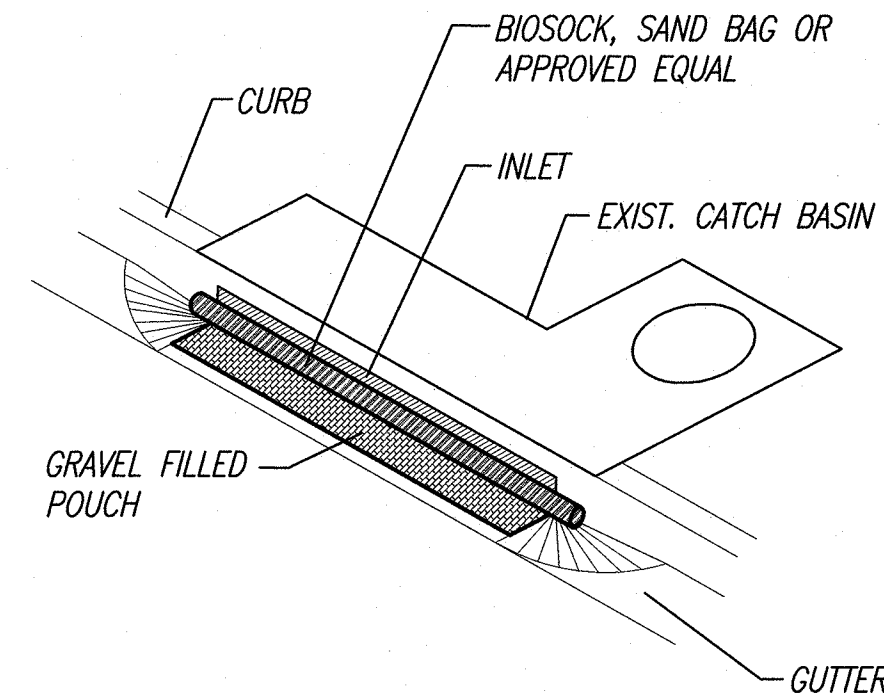

**DETAIL - SEDIMENT CONTROL FILTER
AT EXISTING CATCH BASIN**
NOT TO SCALE

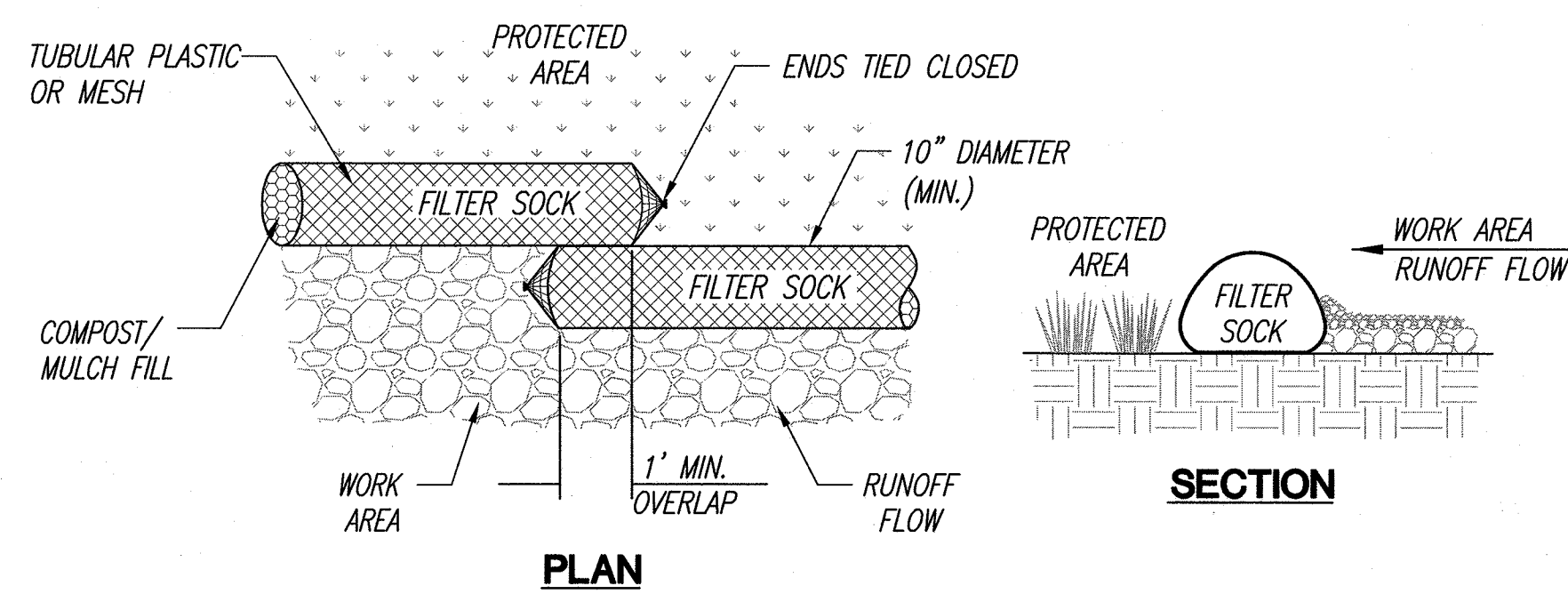

DETAIL - FILTER SOCK
NOT TO SCALE

- NOTES :
1. REMOVE ACCUMULATED SEDIMENT WHEN DEPTH REACHES $\frac{1}{3}$ THE BARRIER HEIGHT.
 2. AT COMPLETION OF PROJECT, FILTER SOCKS MATERIAL INCLUDING THE COMPOST SHALL BE REMOVED FROM SITE AND DISPOSED OF PROPERLY.

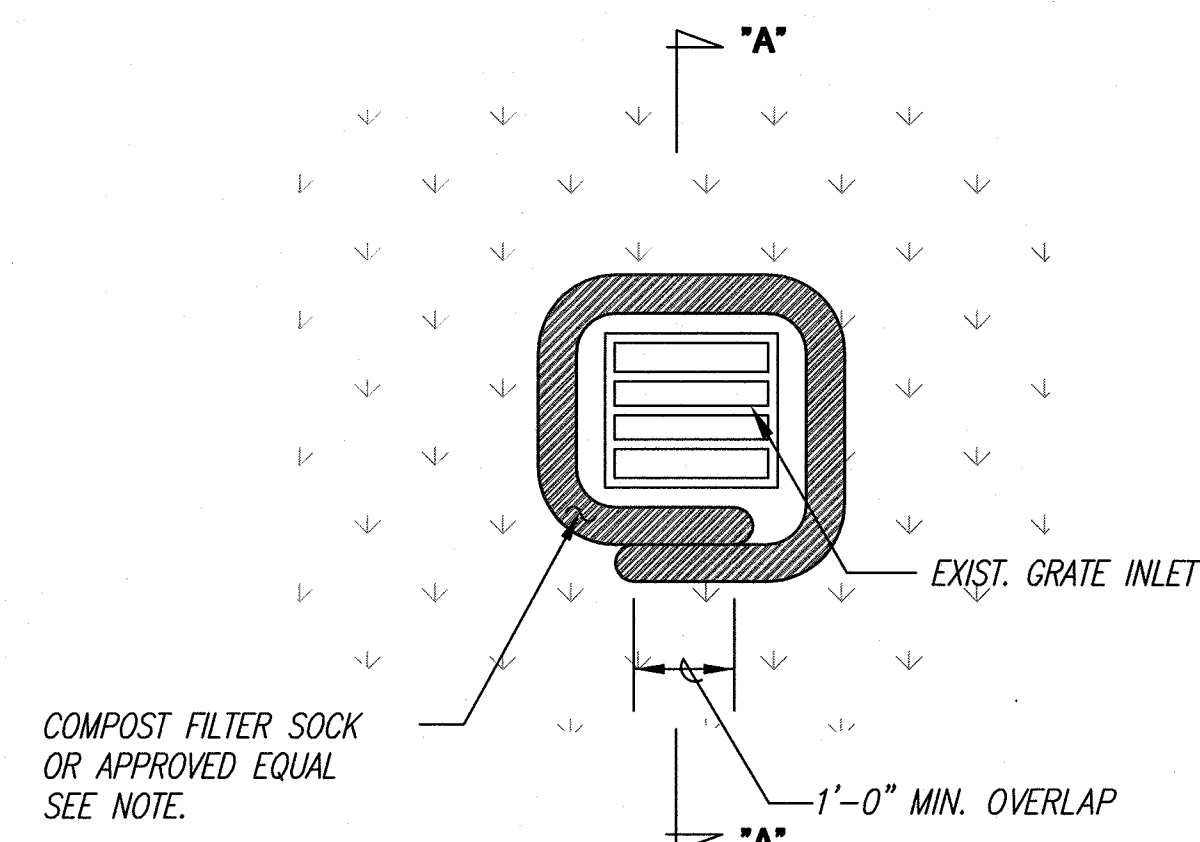

**DETAIL - FILTER BARRIER
AROUND EXIST. GRATE INLET**
NOT TO SCALE

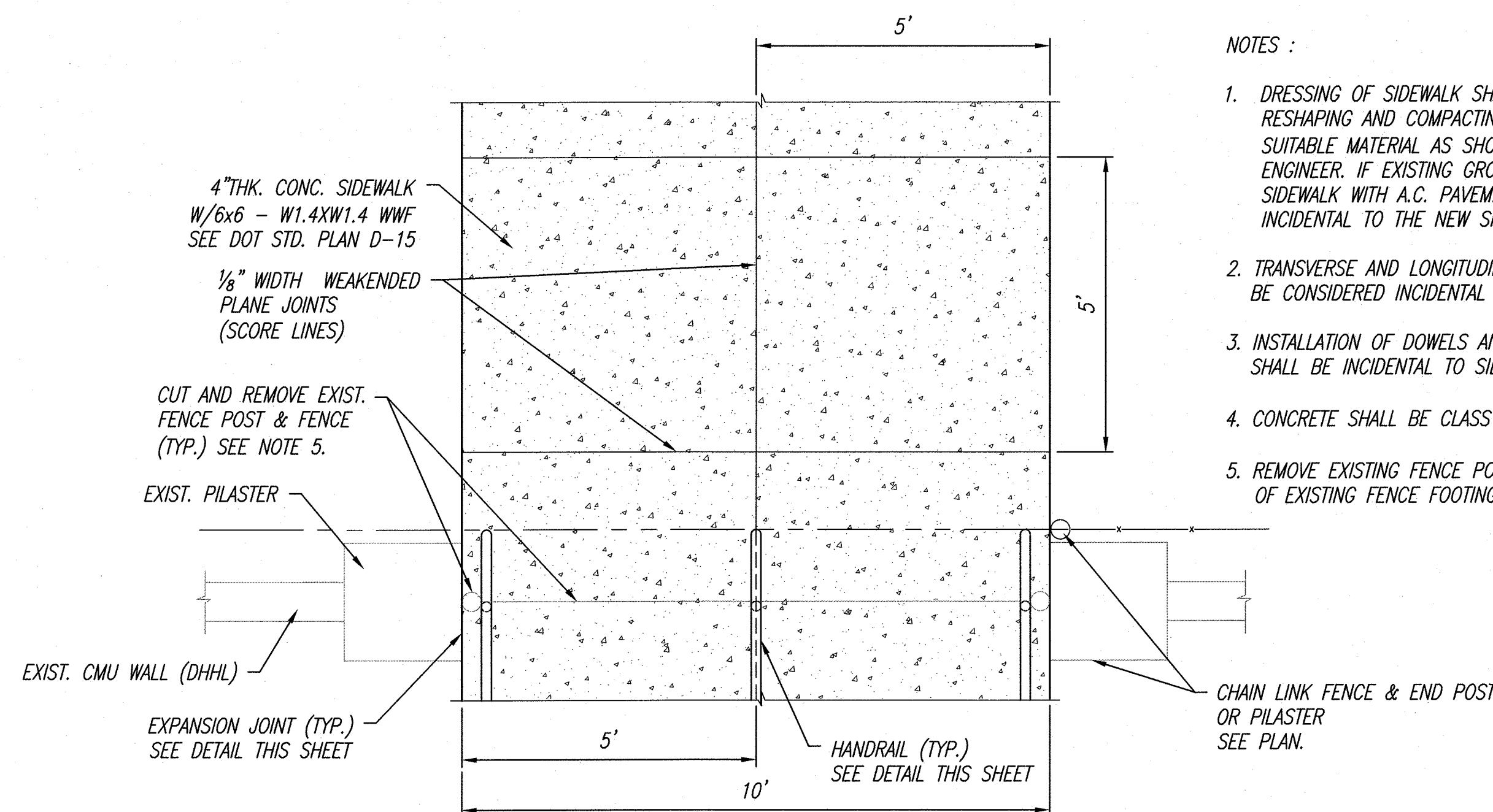

CONCRETE SIDEWALK DETAIL
NOT TO SCALE

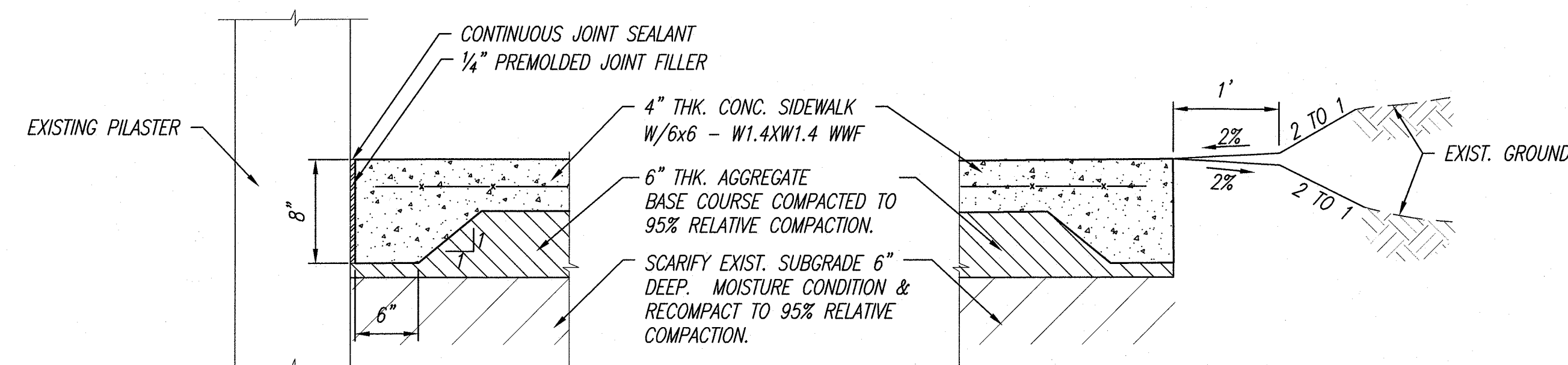

EXPANSION JOINT AT EXISTING PILASTER DETAIL
NOT TO SCALE

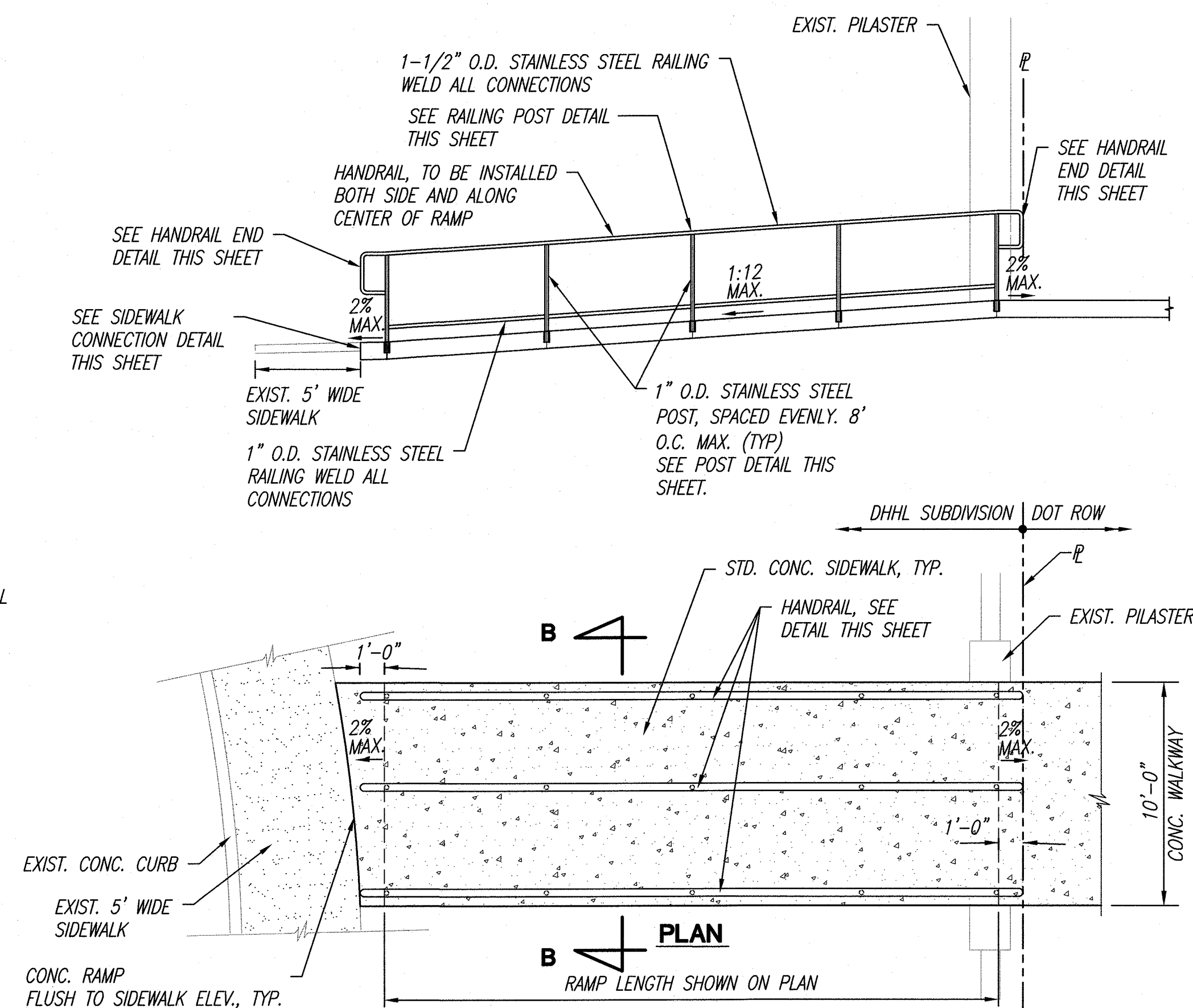

RAMP DETAILS
NOT TO SCALE

NOTES :

1. DRESSING OF SIDEWALK SHALL CONSIST OF CLEARING, GRUBBING, GRADING, RESHAPING AND COMPACTING THE AREA ADJACENT TO THE IMPROVEMENT WITH SUITABLE MATERIAL AS SHOWN ON THE PLANS AND/OR AS DIRECTED BY THE ENGINEER. IF EXISTING GROUND IS ASPHALT OR CONCRETE SURFACE, DRESS SIDEWALK WITH A.C. PAVEMENT, MIX NO. V. THIS WORK SHALL BE CONSIDERED INCIDENTAL TO THE NEW SIDEWALK.
2. TRANSVERSE AND LONGITUDINAL WEAKENED PLANE JOINTS FOR SIDEWALK SHALL BE CONSIDERED INCIDENTAL TO THE NEW SIDEWALK.
3. INSTALLATION OF DOWELS AND TIE BARS, INCLUDING DRILLING AND EPOXY GROUT, SHALL BE INCIDENTAL TO SIDEWALK.
4. CONCRETE SHALL BE CLASS "A"
5. REMOVE EXISTING FENCE POST 12" MIN. BELOW THE FINISH GRADE OR TO THE TOP OF EXISTING FENCE FOOTING WHICHEVER IS GREATER.

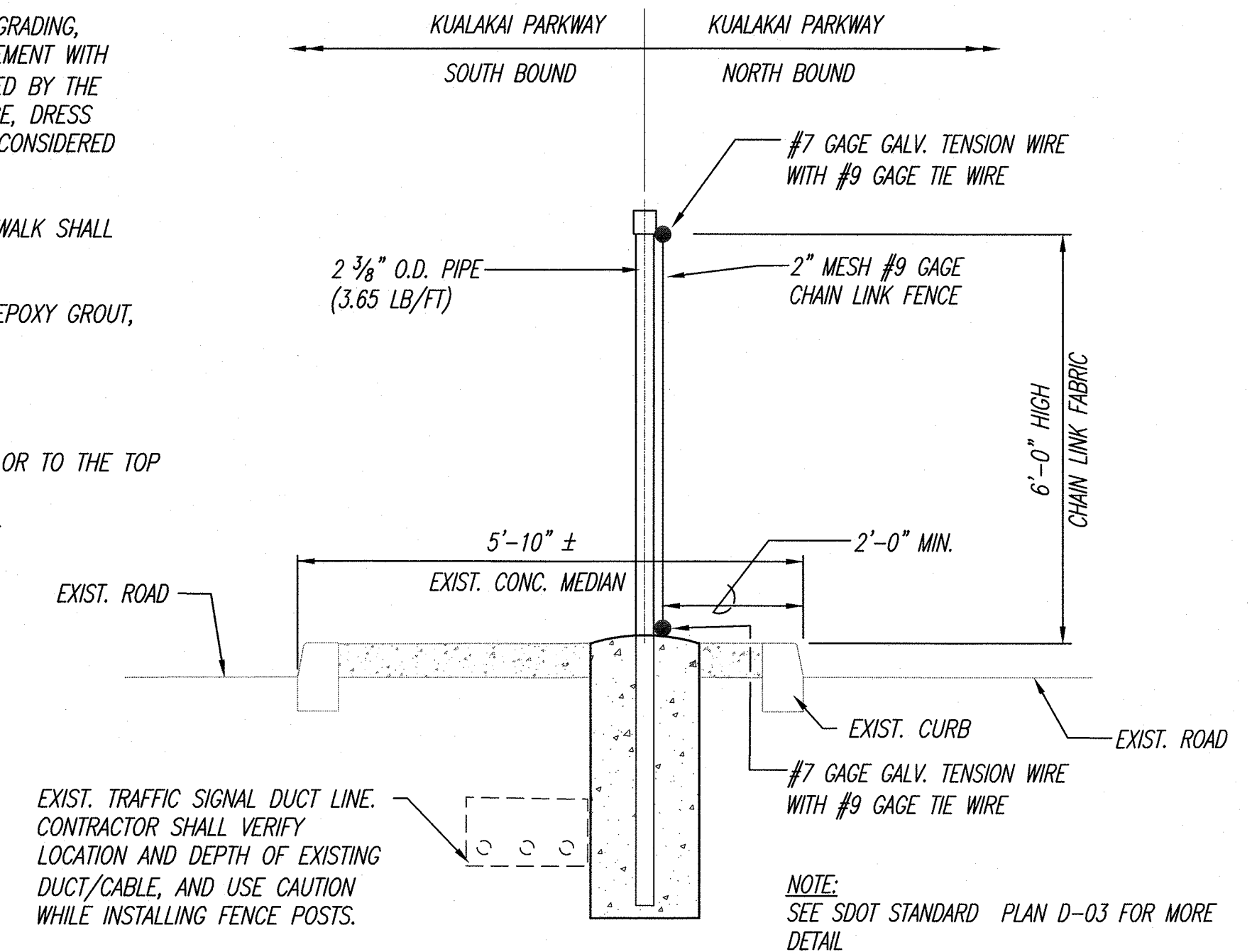

FENCE SECTION AT EXISTING CONC. MEDIAN
NOT TO SCALE

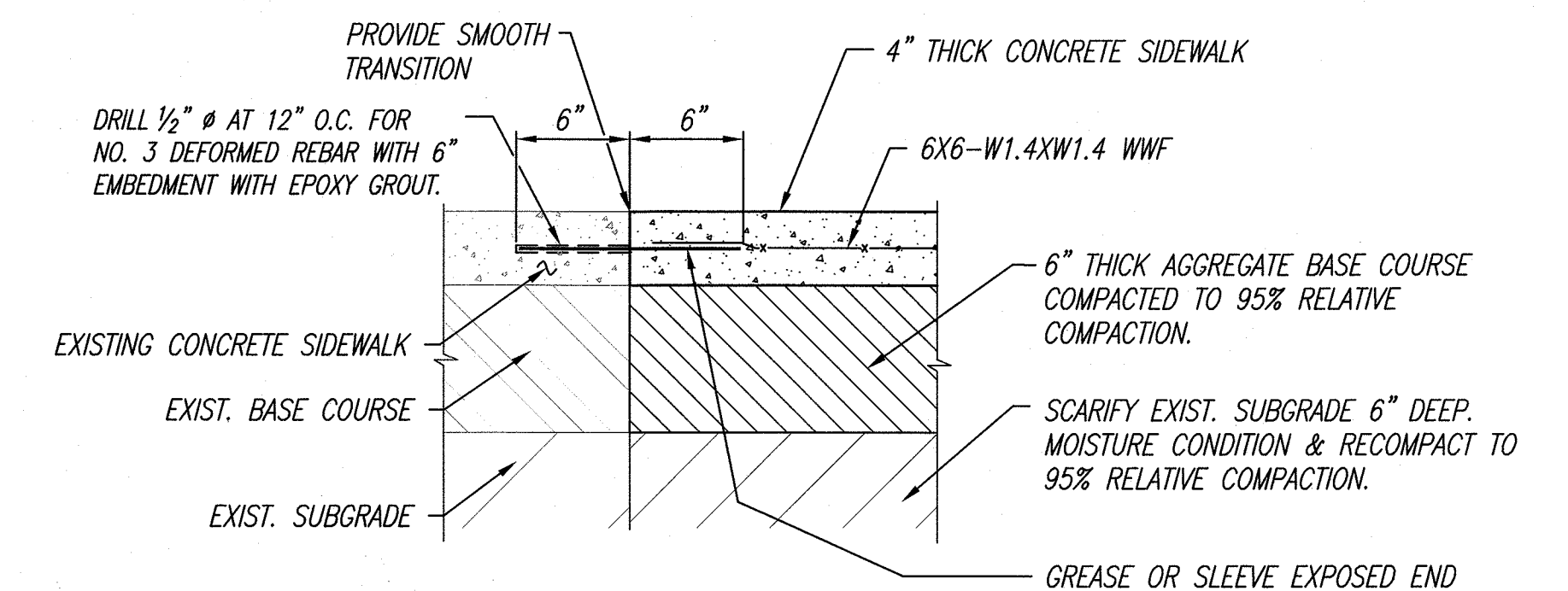

SIDEWALK CONNECTION DETAIL
NOT TO SCALE

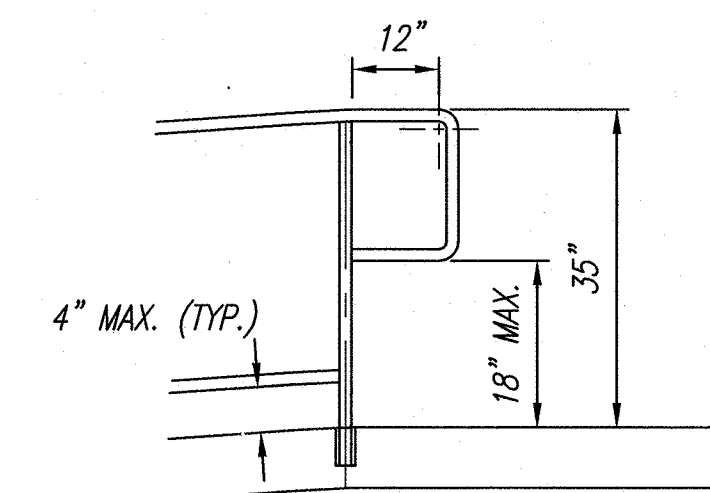

HANDRAIL END DETAIL

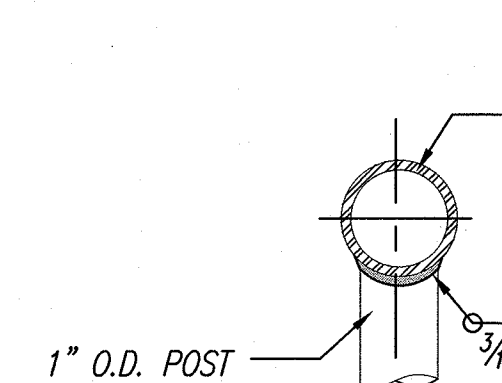

RAILING POST DETAIL

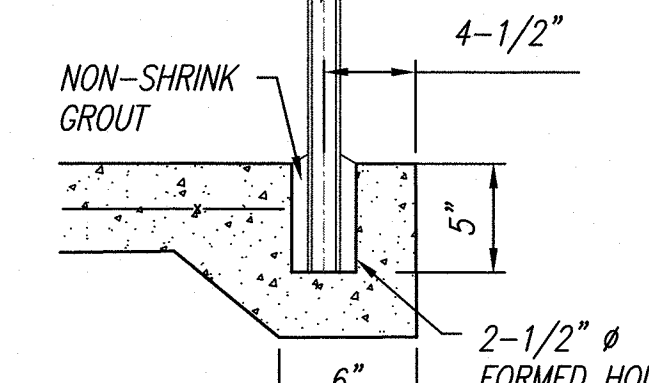

POST DETAIL

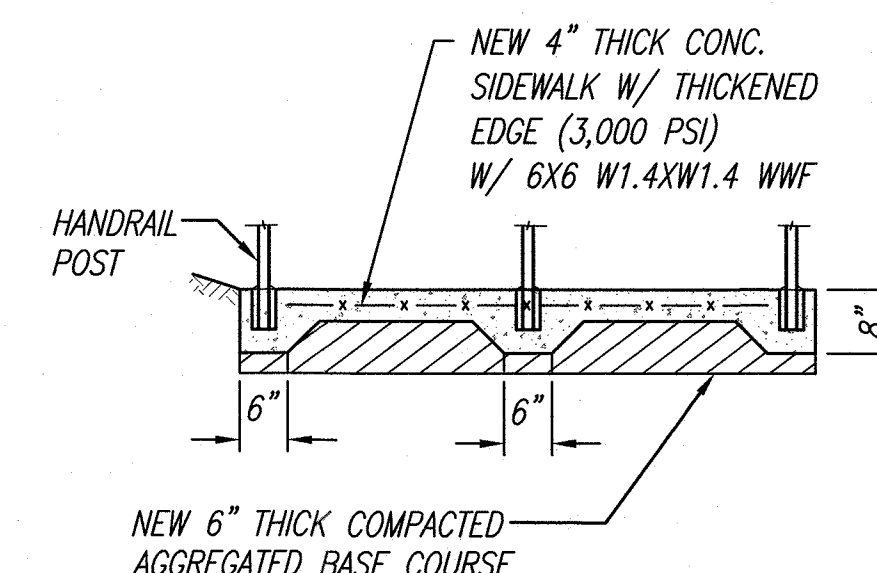

SECTION B-B

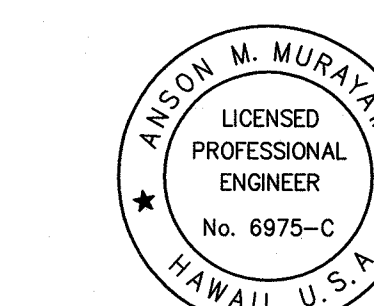

THIS WORK WAS PREPARED BY ME OR UNDER MY SUPERVISION. CONSTRUCTION OF THIS PROJECT WILL BE UNDER MY OBSERVATION. LICENSE EXPIRATION DATE: 04/30/20

REVISION DATE	DESCRIPTION	MADE BY	APPROVED
Community Planning and Engineering, Inc. Engineering Design Construction Management Infrastructure Planning 1286 Queen Emma Street Honolulu, Hawaii			
KANEHILI PEDESTRIAN ACCESS HONOLULU, EWA, OAHU, HAWAII OWNER AND DEVELOPER: DEPARTMENT OF TRANSPORTATION DEPARTMENT OF HAWAIIAN HOME LANDS TAX MAP KEY: 9-1-017:096, 9-1-151:001, 9-1-152:160, 9-1-153:194			
DETAILS			
DRAWN BY: HWH	ENGINEER: SS, HWH	CHECKED BY: AM	
APPROVED:			
DWG. NO. C-5 SHEET 6 OF 7 SHEETS FILE POCKET FOLDER NO.			

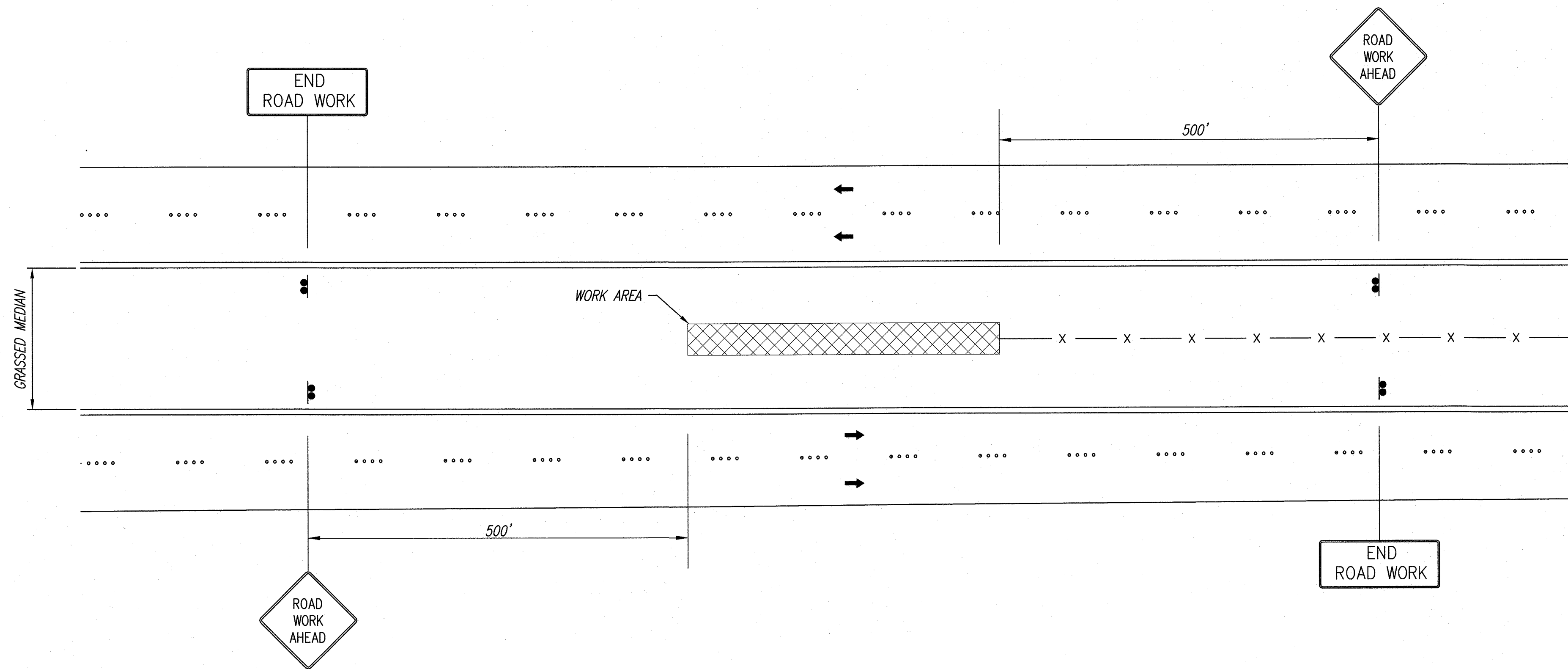

LEGEND

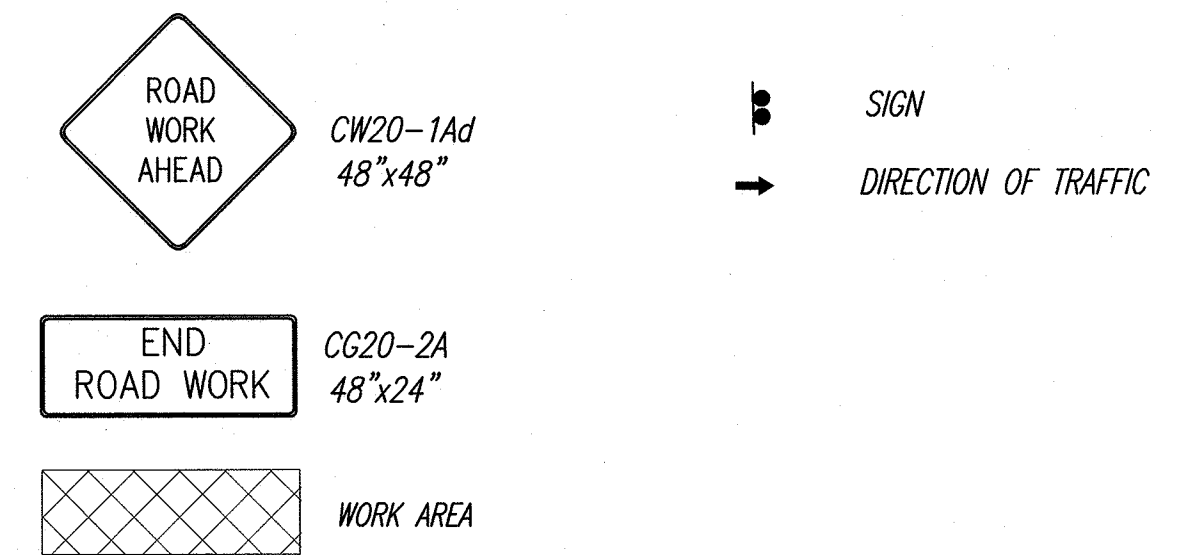

GENERAL NOTES FOR TRAFFIC CONTROL PLAN

1. THE PERMITTEE SHALL MAKE MINOR ADJUSTMENTS AT INTERSECTIONS, DRIVEWAYS, BRIDGES, STRUCTURES, ETC., TO FIT FIELD CONDITIONS.
2. TRAFFIC CONTROL DEVICES SHALL BE INSTALLED SUCH THAT THE SIGN OR DEVICE FARTHEST FROM THE WORK AREA SHALL BE PLACED FIRST. THE OTHERS SHALL THEN BE PLACED PROGRESSIVELY TOWARD THE WORK AREA.
3. REGULATORY AND WARNING SIGNS WITHIN THE CONSTRUCTION ZONE THAT ARE IN CONFLICT WITH THE TRAFFIC CONTROL PLANS SHALL BE REMOVED OR COVERED. ALL SIGNS SHALL BE RESTORED UPON COMPLETION OF THE WORK.
4. WHEN REQUIRED BY THE ISSUING OFFICE, THE PERMITTEE SHALL INSTALL A FLASHING ARROW SIGNAL AS DIRECTED BY THE ISSUING OFFICE.
5. ALL CONSTRUCTION WARNING SIGNS SHALL BE PROMPTLY REMOVED OR COVERED WHENEVER THE MESSAGE IS NOT APPLICABLE OR NOT IN USE.
6. THE BACKS OF ALL SIGNS USED FOR TRAFFIC CONTROL SHALL BE APPROPRIATELY COVERED TO PRECLUDE THE DISPLAY OF INAPPLICABLE SIGN MESSAGES (I.E., WHEN SIGNS HAVE MESSAGES ON BOTH FACES).
7. AT THE END OF EACH DAY'S WORK OR AS SOON AS THE WORK IS COMPLETED, THE PERMITTEE SHALL REMOVE ALL TRAFFIC CONTROL DEVICES NO LONGER NEEDED TO PERMIT FREE AND SAFE PASSAGE OF PUBLIC TRAFFIC. REMOVAL SHALL BE IN THE REVERSE ORDER OF INSTALLATION. EXISTING FADED OR OBLITERATED PAVEMENT MARKINGS THAT ARE NECESSARY FOR SAFE TRAFFIC FLOW IN THE CONSTRUCTION AREA SHALL BE REPLACED WITH TEMPORARY OR PERMANENT MARKINGS BEFORE OPENING THE ROADWAY TO PUBLIC TRAFFIC EACH DAY.
8. PERMANENT PAVEMENT MARKINGS AND TRAFFIC SIGNS SHALL BE REPLACED UPON COMPLETION OF EACH PHASE OF WORK.
9. DRIVEWAYS SHALL BE KEPT OPEN UNLESS THE OWNERS OF THE PROPERTY USING THE RIGHT-OF-WAY ARE OTHERWISE PROVIDED FOR SATISFACTORILY. FURTHER, THE PERMITTEE SHALL CONTROL TRAFFIC GOING IN AND OUT OF DRIVEWAYS.

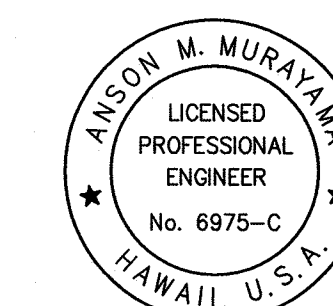

[Signature]

THIS WORK WAS PREPARED BY
ME OR UNDER MY SUPERVISION
CONSTRUCTION OF THIS PROJECT
WILL BE UNDER MY OBSERVATION.
LICENSE EXPIRATION DATE: 04/30/20

REVISION DATE	DESCRIPTION	MADE BY	APPROVED
Community Planning and Engineering, Inc. Engineering Design Construction Management Infrastructure Planning 1286 Queen Emma Street Honolulu, Hawaii			
KANEHILI PEDESTRIAN ACCESS HONOLULU, EWA, OAHU, HAWAII OWNER AND DEVELOPER: DEPARTMENT OF TRANSPORTATION DEPARTMENT OF HAWAIIAN HOME LANDS TAX MAP KEY: 9-1-017:096, 9-1-151:001, 9-1-152:160, 9-1-153:194			
TRAFFIC CONTROL PLAN			
DRAWN BY: HW1	ENGINEER: SS, HW1	CHECKED BY: AM	
APPROVED:			